

WHEN CONSTRUCTING RAMP IN EXISTING CURB AND GUTTER, PLACE 1/2" ISOLATION JOINT WHERE NEW CONSTRUCTION ABUTS EXISTING. IF AN EXISTING JOINT IS MORE THAN 3' AWAY, PLACE 1/2" ISOLATION JOINT AT THIS LOCATION.

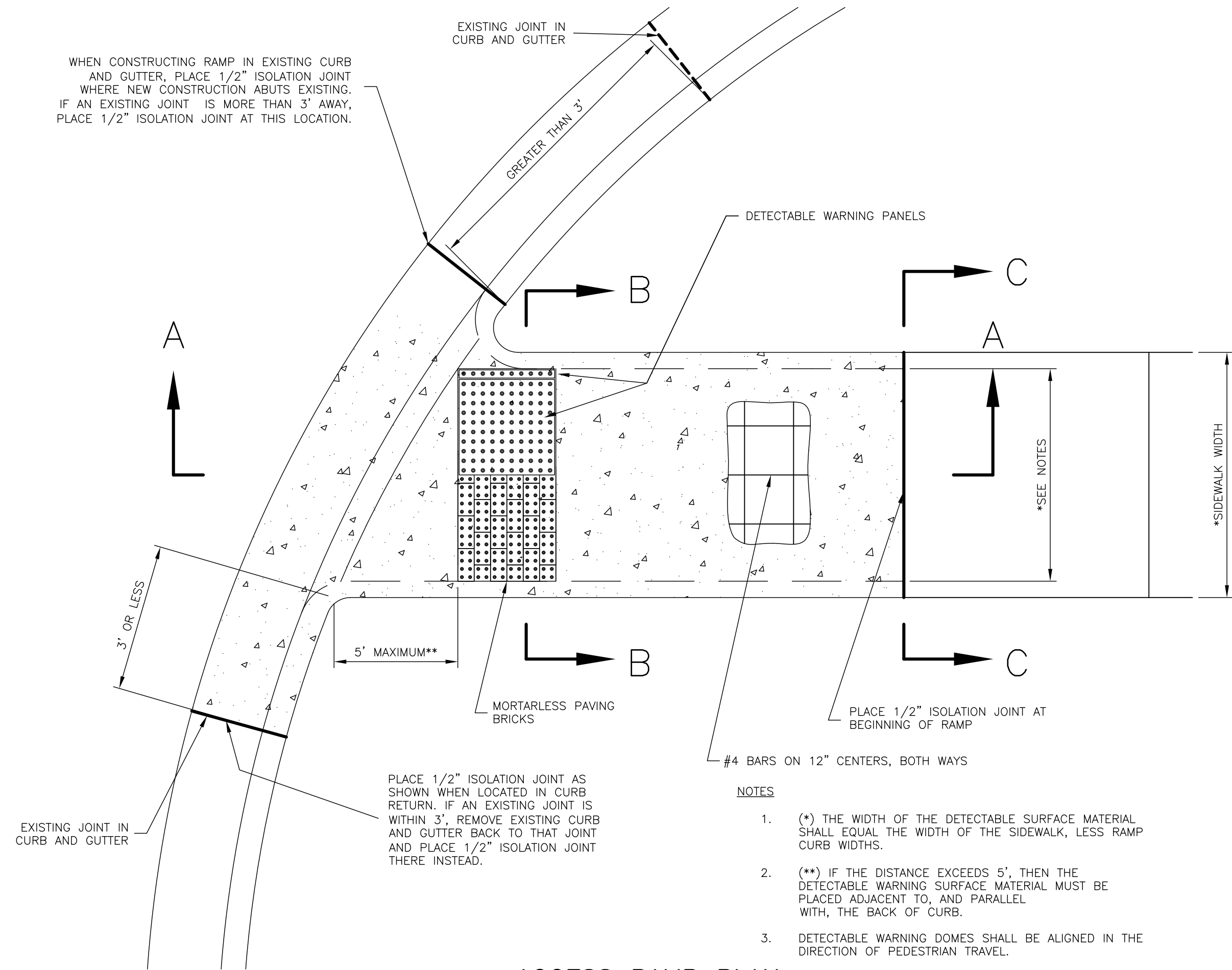

ACCESS RAMP PLAN

NOTES

- (*) THE WIDTH OF THE DETECTABLE SURFACE MATERIAL SHALL EQUAL THE WIDTH OF THE SIDEWALK, LESS RAMP CURB WIDTHS.
- (**) IF THE DISTANCE EXCEEDS 5', THEN THE DETECTABLE WARNING SURFACE MATERIAL MUST BE PLACED ADJACENT TO, AND PARALLEL WITH, THE BACK OF CURB.
- DETECTABLE WARNING DOMES SHALL BE ALIGNED IN THE DIRECTION OF PEDESTRIAN TRAVEL.

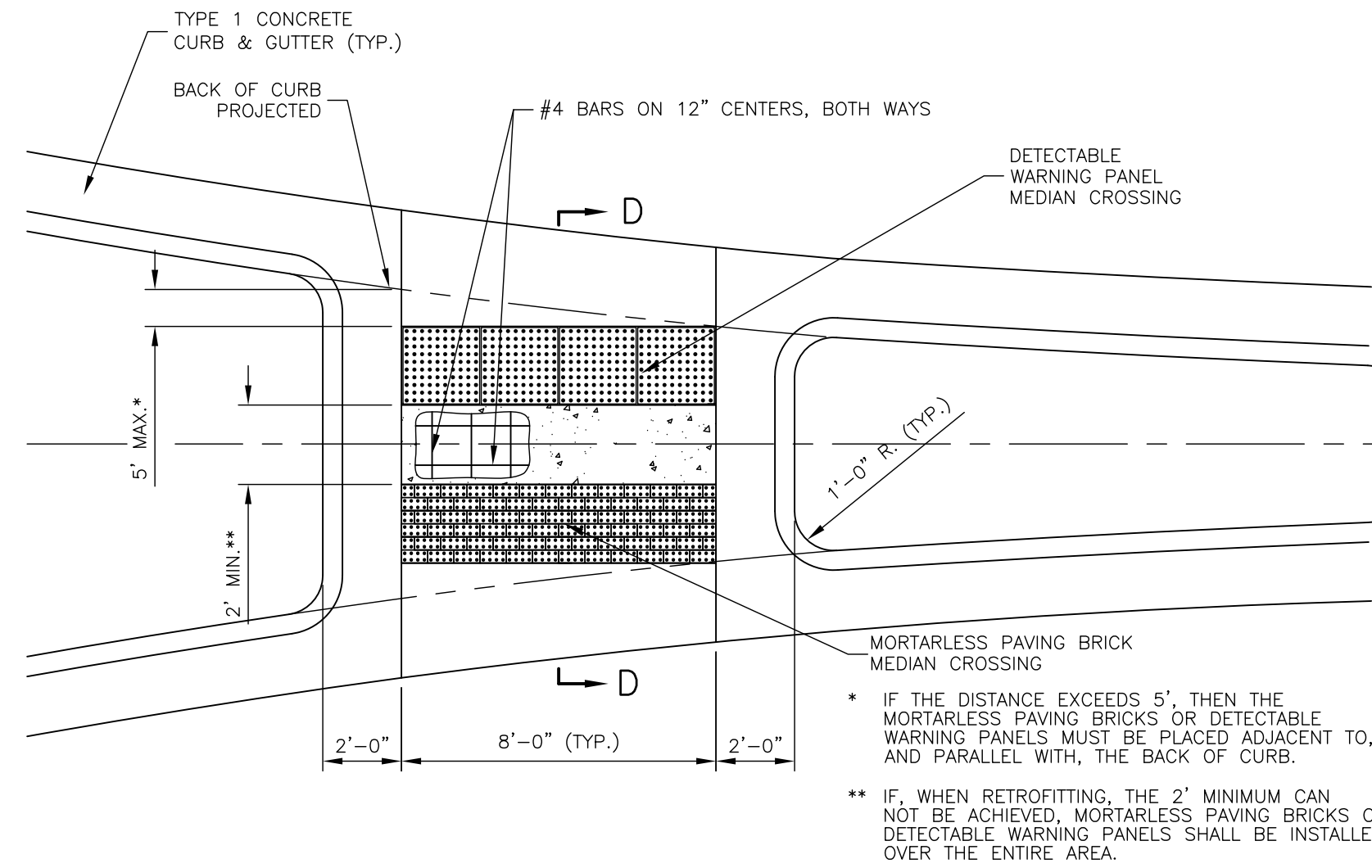

MEDIAN RAMP CROSSING PLAN

MEDIAN RAMP CROSSING DETAILS

SECTION D-D

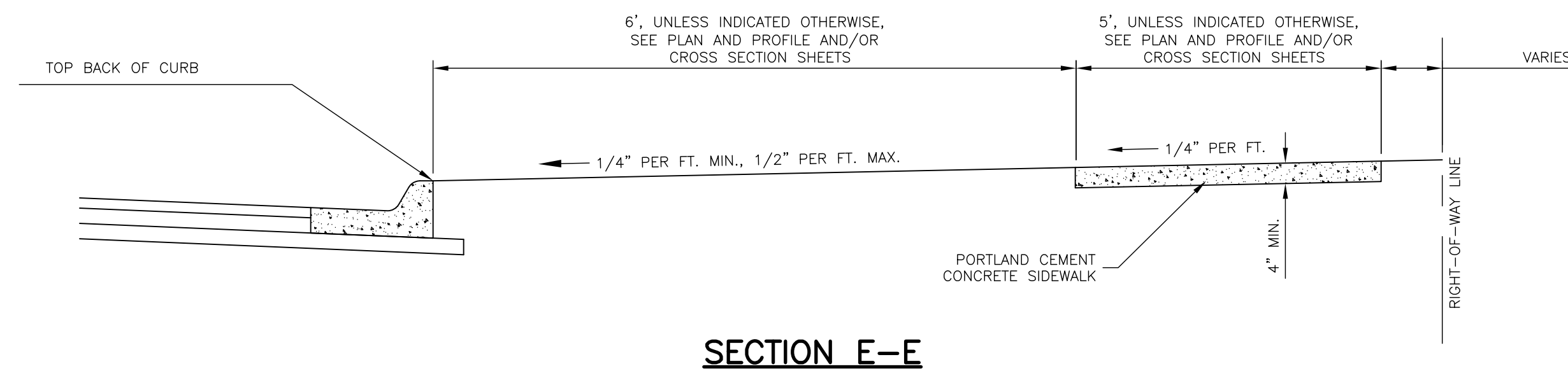

SECTION E-E

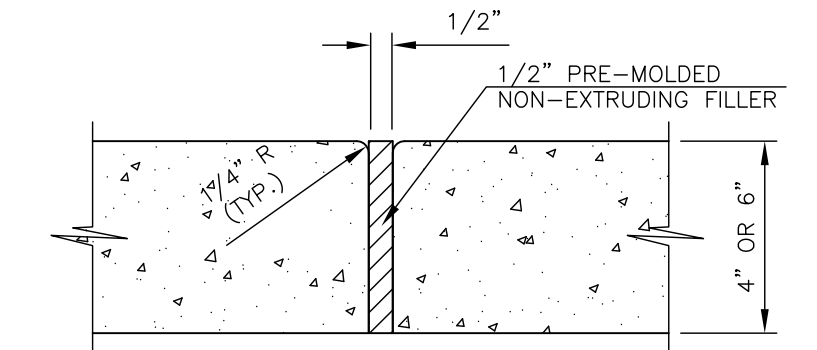

SECTION F-F ISOLATION JOINT

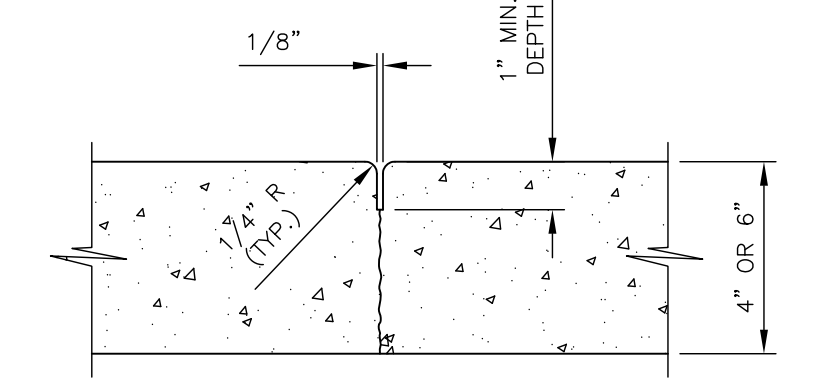

SECTION G-G CONTRACTION JOINT (SAWED OR FORMED)

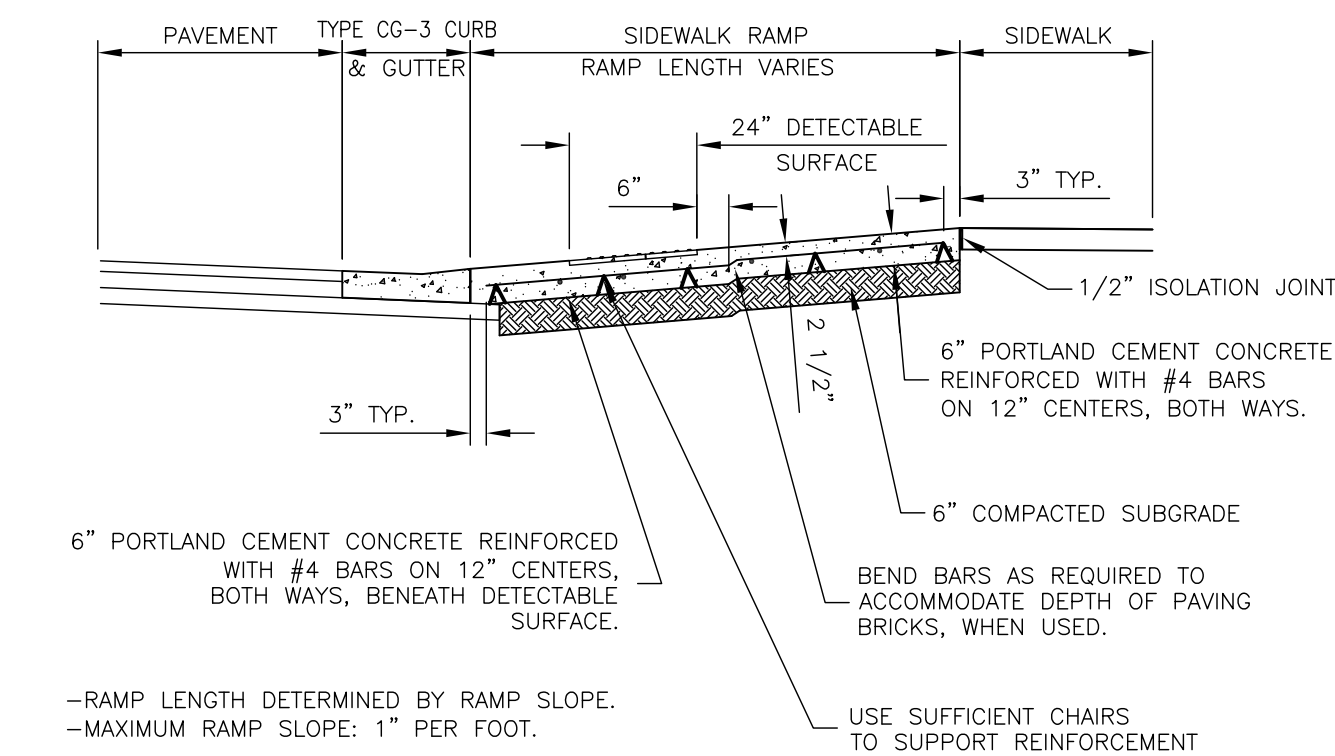

SECTION A-A

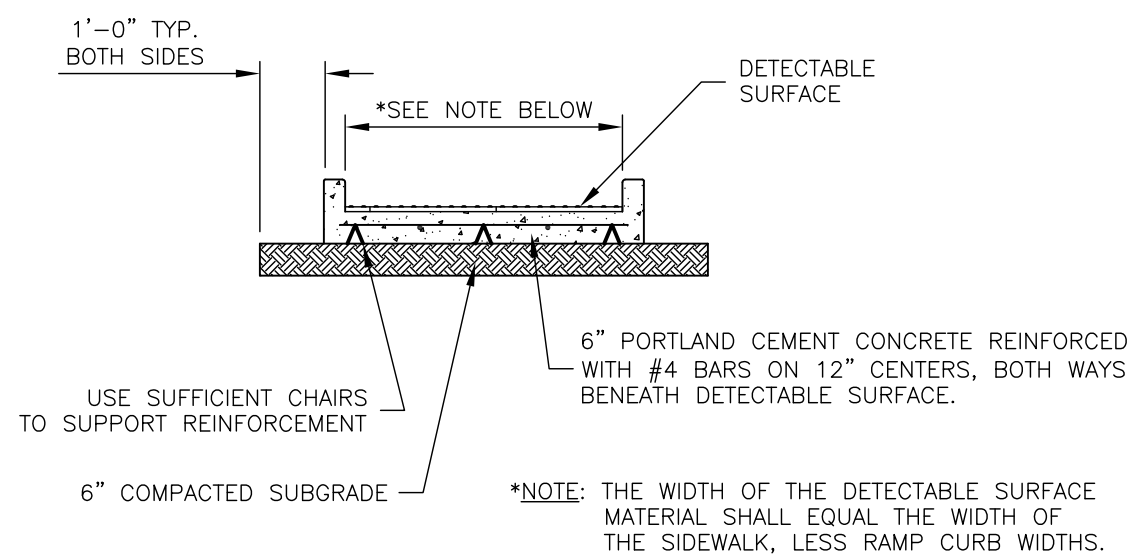

SECTION B-B

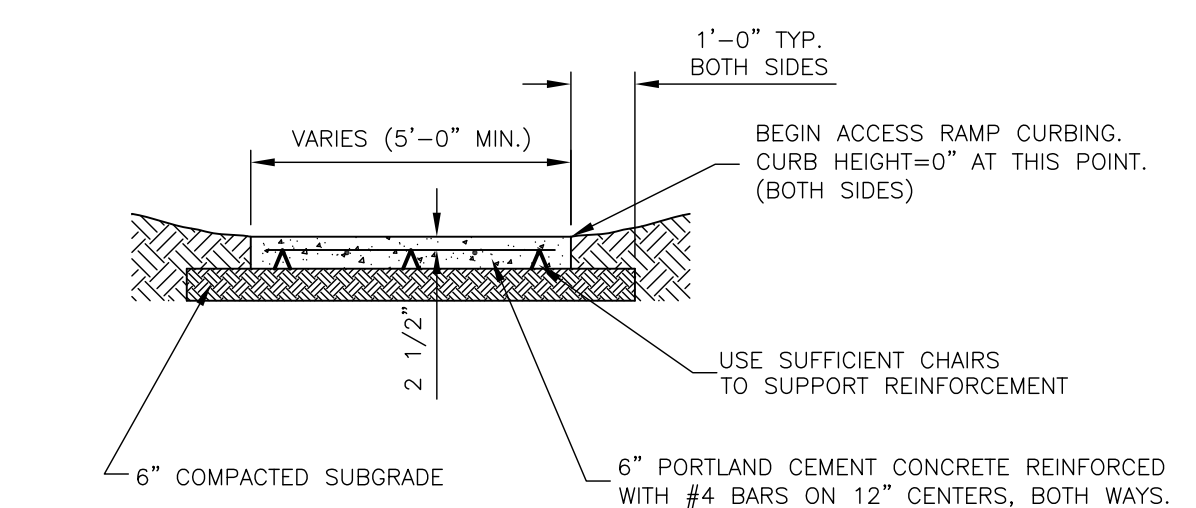

SECTION C-C

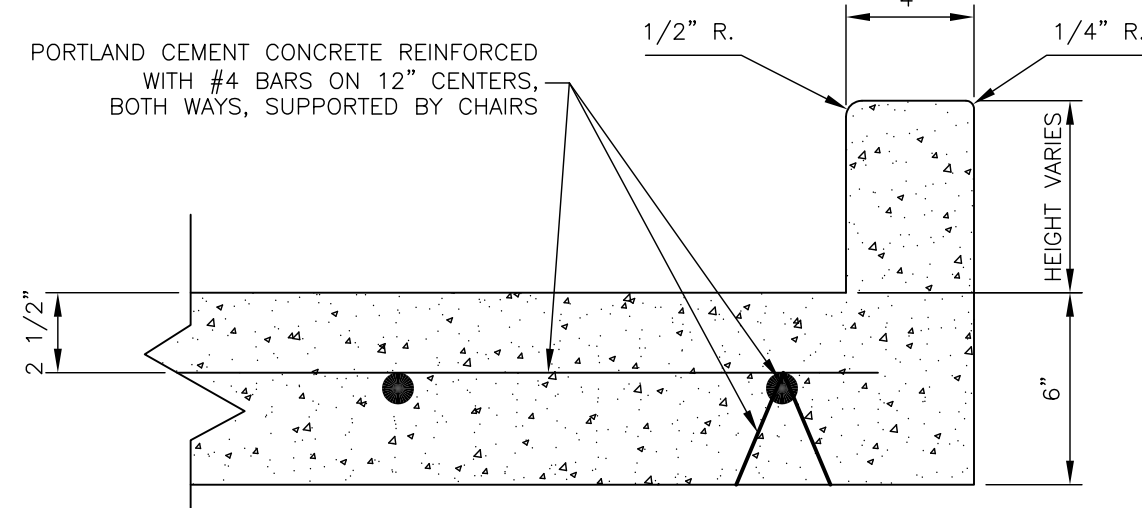

ACCESS RAMP CURB DETAIL

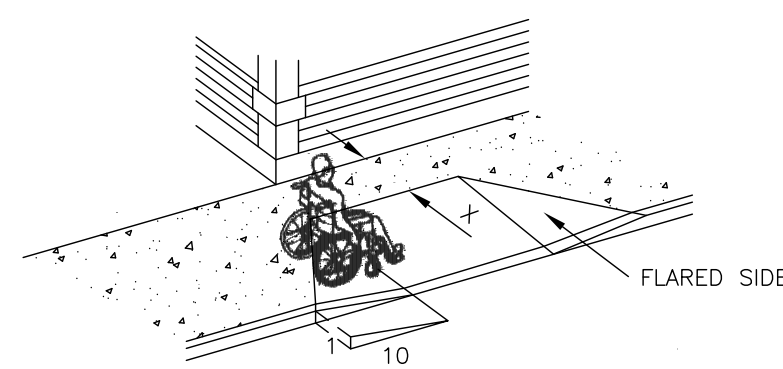

ACCESS RAMP WITH FLARED SIDES

ACCESS RAMP DETAILS

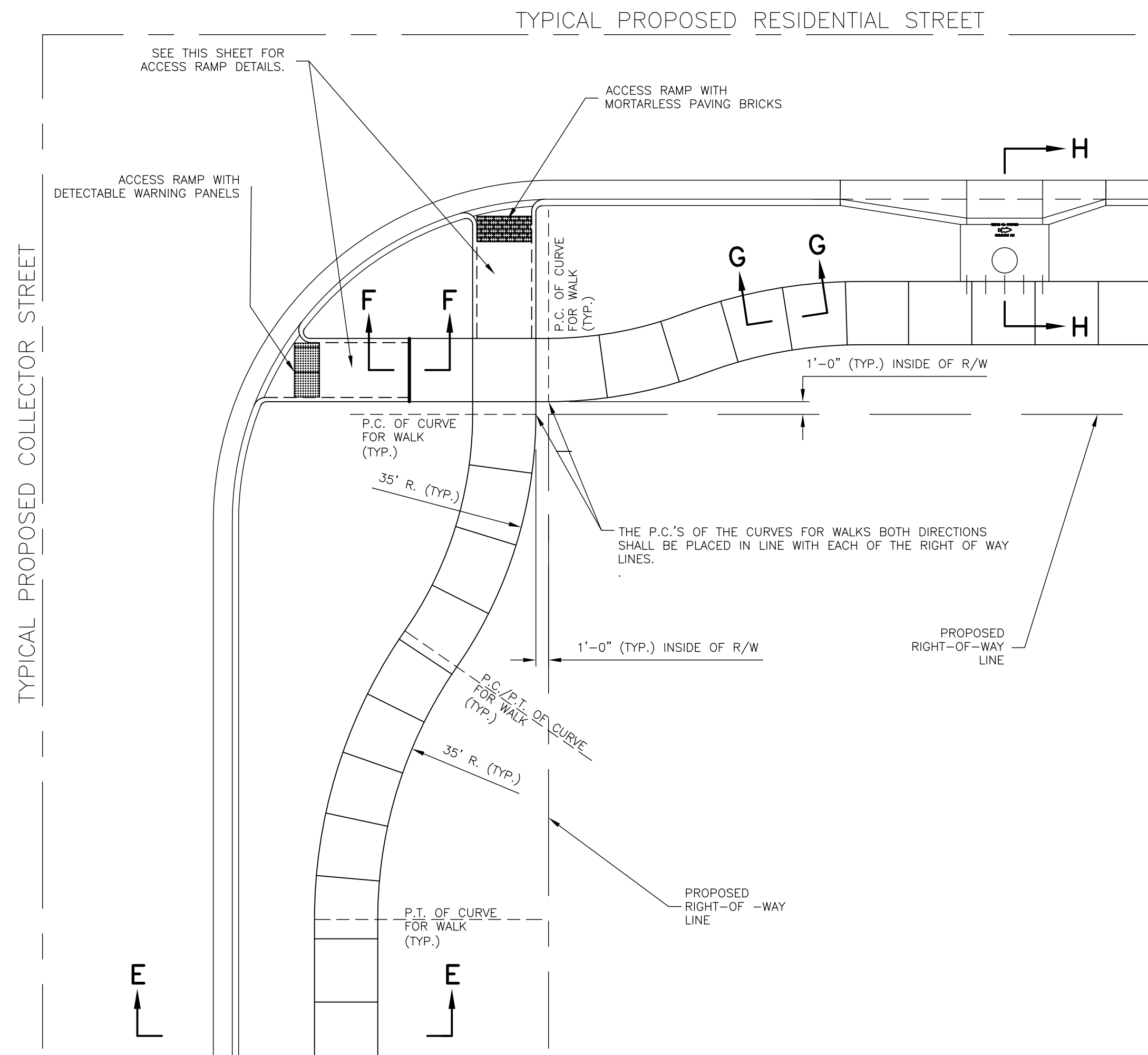

GENERAL SIDEWALK LAYOUT PLAN

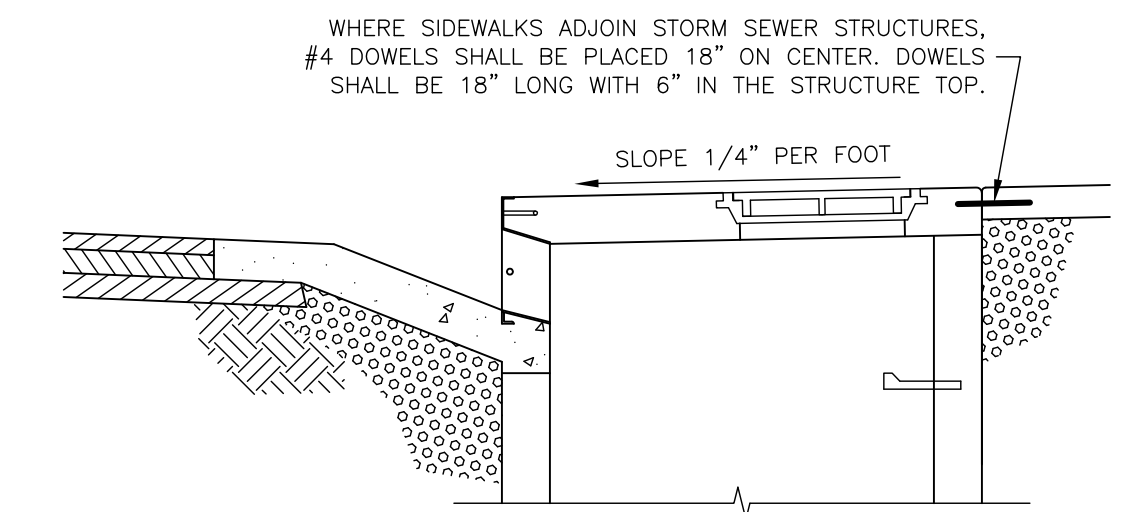

SECTION H-H SIDEWALK TO INLET DOWELING DETAIL

SIDEWALK GENERAL NOTES

- CONSTRUCTION JOINTS SHALL BE PLACED IN 5'-0" WIDE SIDEWALKS AT A MINIMUM OF 5'-0" INTERVALS. WHEN OTHER WIDTHS OF SIDEWALK ARE USED, CONSTRUCTION JOINTS SHALL BE PLACED AS DIRECTED BY THE CITY ENGINEER OR AN AUTHORIZED REPRESENTATIVE.
- ISOLATION JOINTS SHALL BE PLACED AT ALL LOCATIONS WHERE SIDEWALK ABUTS EXISTING STRUCTURES AND AS DIRECTED BY THE CITY ENGINEER OR AN AUTHORIZED REPRESENTATIVE.
- ACCESS RAMPS SHALL BE CONSTRUCTED AT ALL LOCATIONS WHERE SIDEWALKS INTERSECT NEW STREET CONSTRUCTION AND AS OTHERWISE SHOWN ON THE PLANS.

SHEET _____ OF _____

DATE	BY	REVISION
03-20-08	LJM	REPLACES ALL PREVIOUS VERSIONS OF SIDEWALK DETAILS



STANDARD DETAILS FOR CONCRETE SIDEWALKS

SHOEB M. UDDIN CITY ENGINEER **DAVID L. CORLISS** CITY MANAGER