

WHEN CONSTRUCTING RAMP IN EXISTING CURB AND GUTTER, PLACE 1/2" ISOLATION JOINT WHERE NEW CONSTRUCTION ABUTS EXISTING. IF AN EXISTING JOINT IS MORE THAN 3' AWAY, PLACE 1/2" ISOLATION JOINT AT THIS LOCATION.

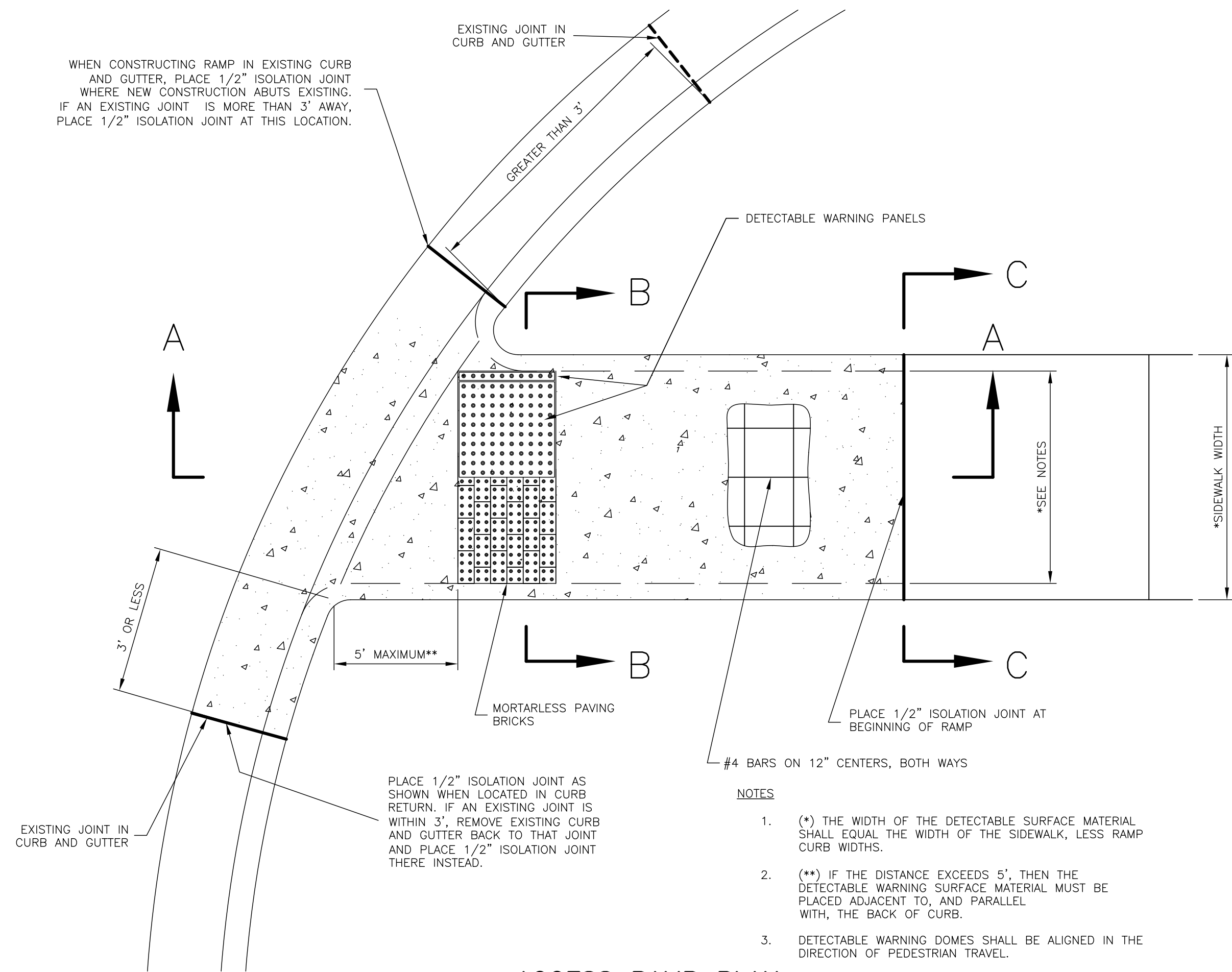

ACCESS RAMP PLAN

NOTES

- (*) THE WIDTH OF THE DETECTABLE SURFACE MATERIAL SHALL EQUAL THE WIDTH OF THE SIDEWALK, LESS RAMP CURB WIDTHS.
- (**) IF THE DISTANCE EXCEEDS 5', THEN THE DETECTABLE WARNING SURFACE MATERIAL MUST BE PLACED ADJACENT TO, AND PARALLEL WITH, THE BACK OF CURB.
- DETECTABLE WARNING DOMES SHALL BE ALIGNED IN THE DIRECTION OF PEDESTRIAN TRAVEL.

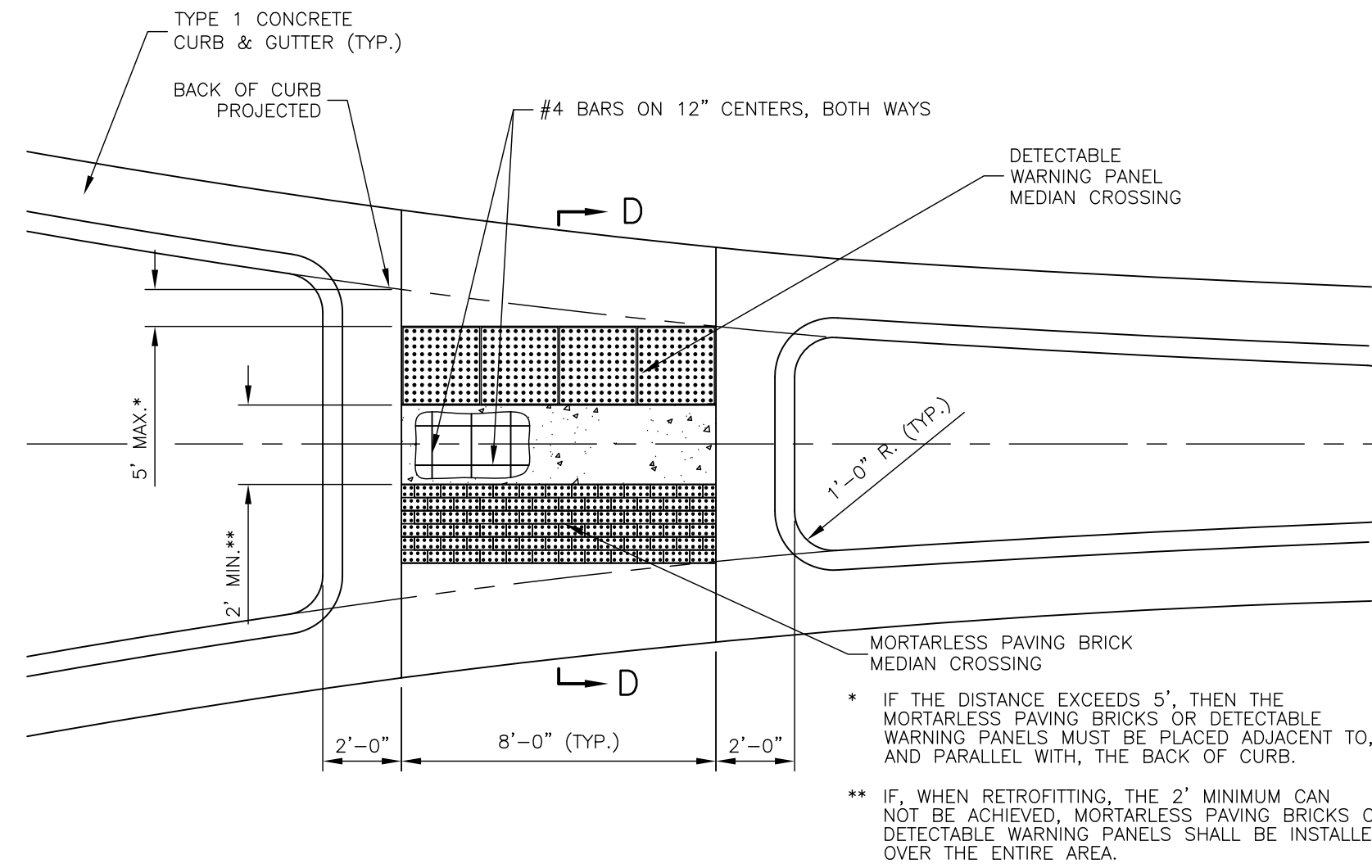

MEDIAN RAMP CROSSING PLAN

MEDIAN RAMP CROSSING DETAILS

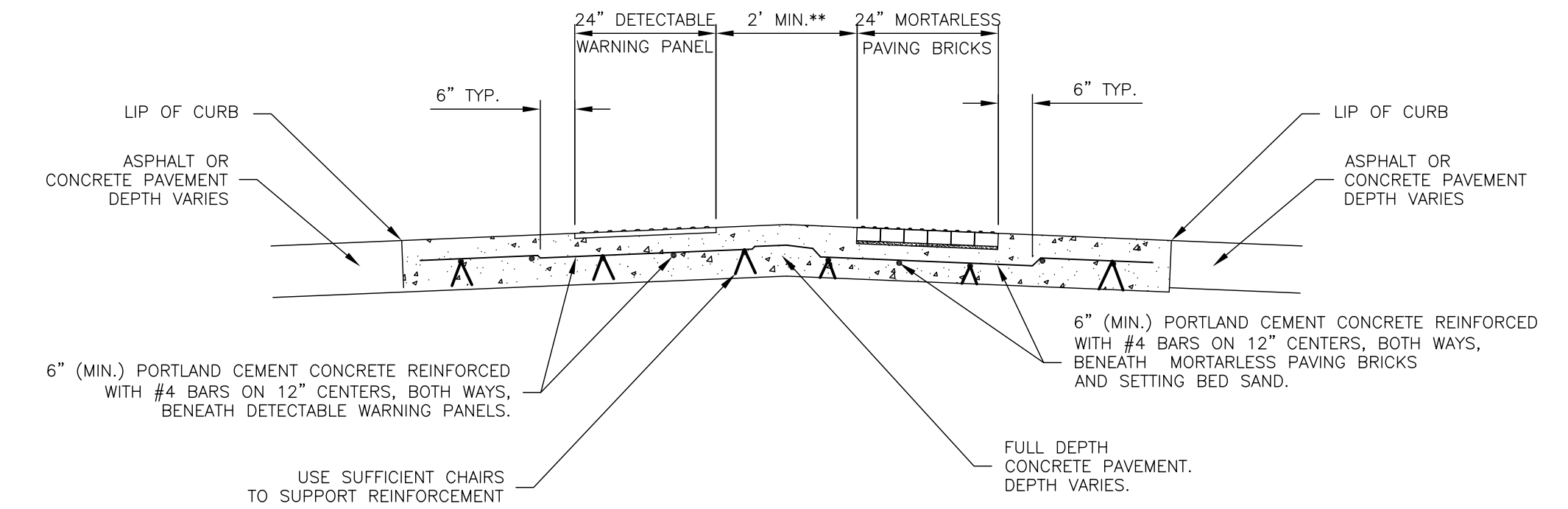

SECTION D-D

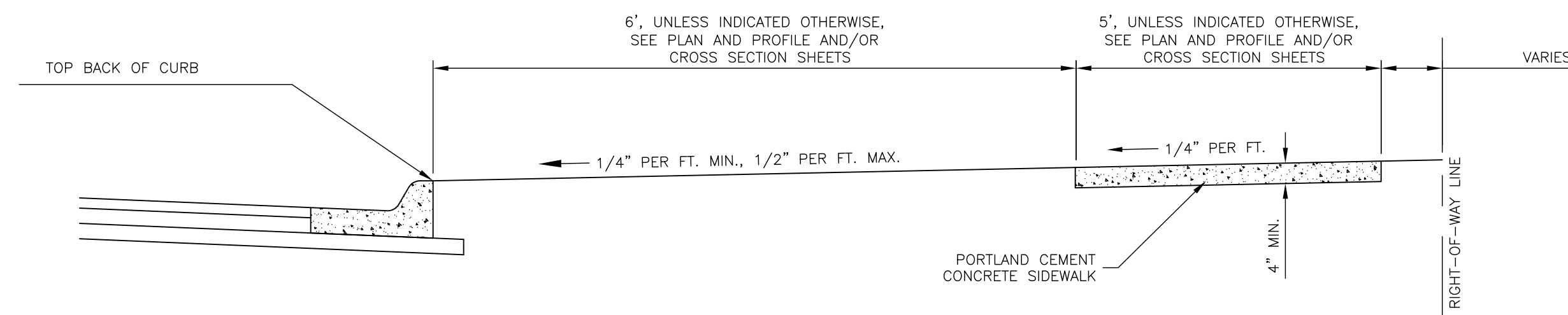

SECTION E-E

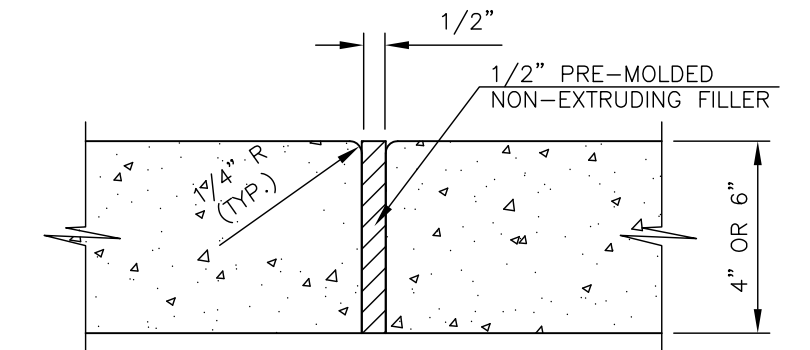

SECTION F-F ISOLATION JOINT

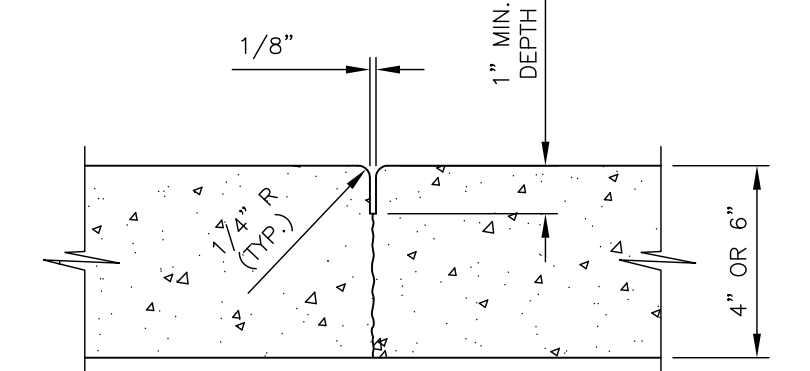

SECTION G-G CONTRACTION JOINT (SAWED OR FORMED)

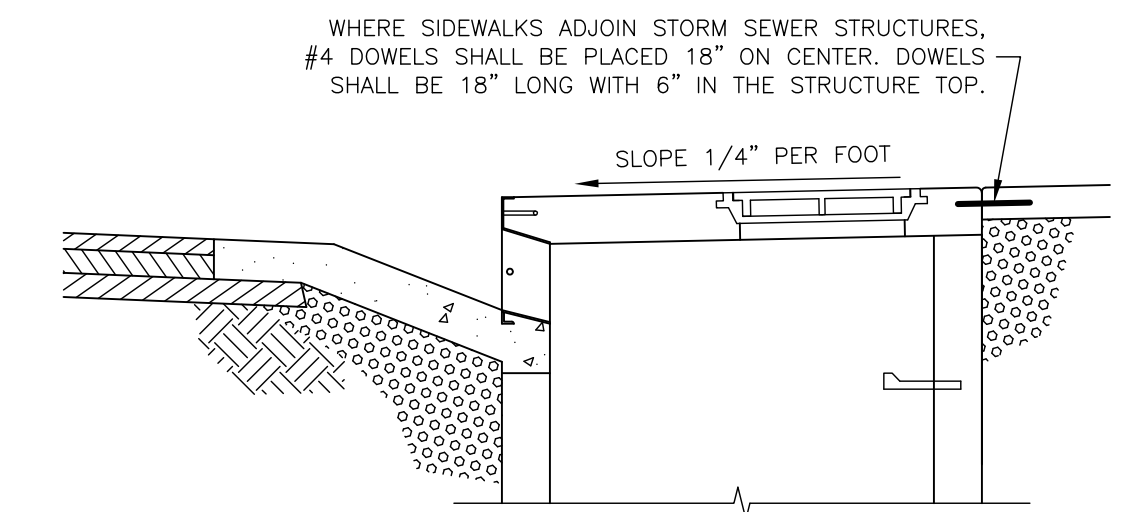

SECTION H-H SIDEWALK TO INLET DOWELING DETAIL

SIDEWALK GENERAL NOTES

- CONSTRUCTION JOINTS SHALL BE PLACED IN 5'-0" WIDE SIDEWALKS AT A MINIMUM OF 5'-0" INTERVALS. WHEN OTHER WIDTHS OF SIDEWALK ARE USED, CONSTRUCTION JOINTS SHALL BE PLACED AS DIRECTED BY THE CITY ENGINEER OR AN AUTHORIZED REPRESENTATIVE.
- ISOLATION JOINTS SHALL BE PLACED AT ALL LOCATIONS WHERE SIDEWALK ABUTS EXISTING STRUCTURES AND AS DIRECTED BY THE CITY ENGINEER OR AN AUTHORIZED REPRESENTATIVE.
- ACCESS RAMPS SHALL BE CONSTRUCTED AT ALL LOCATIONS WHERE SIDEWALKS INTERSECT NEW STREET CONSTRUCTION AND AS OTHERWISE SHOWN ON THE PLANS.

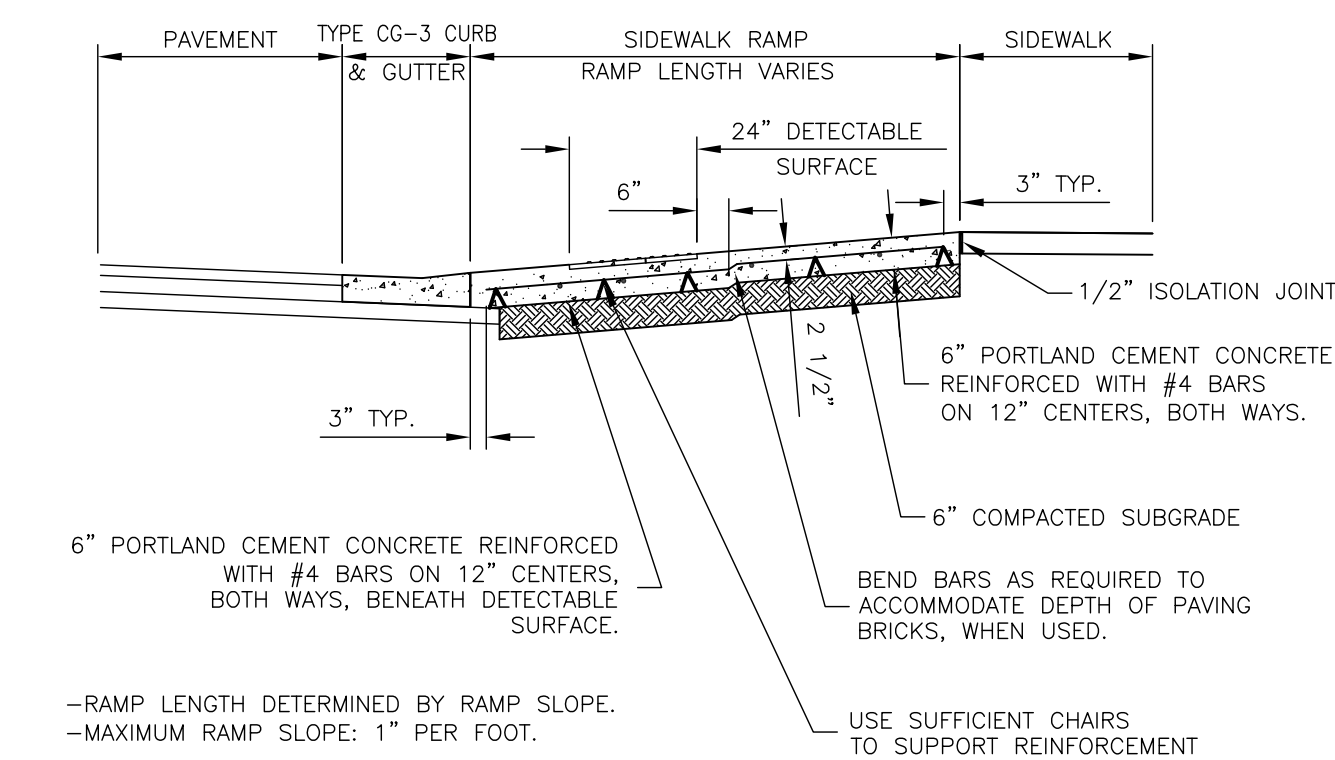

SECTION A-A

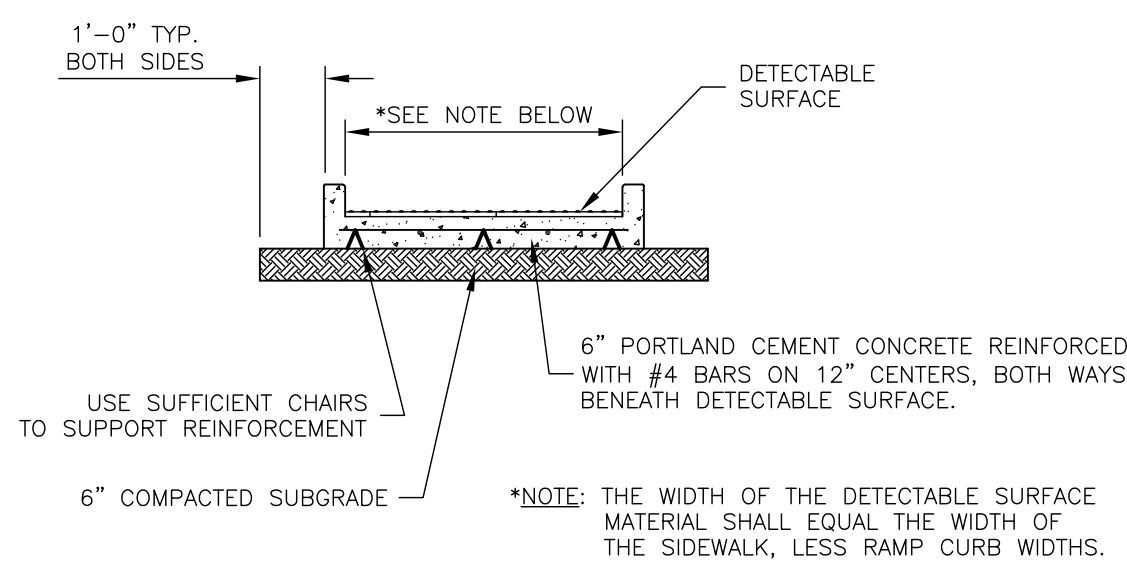

SECTION B-B

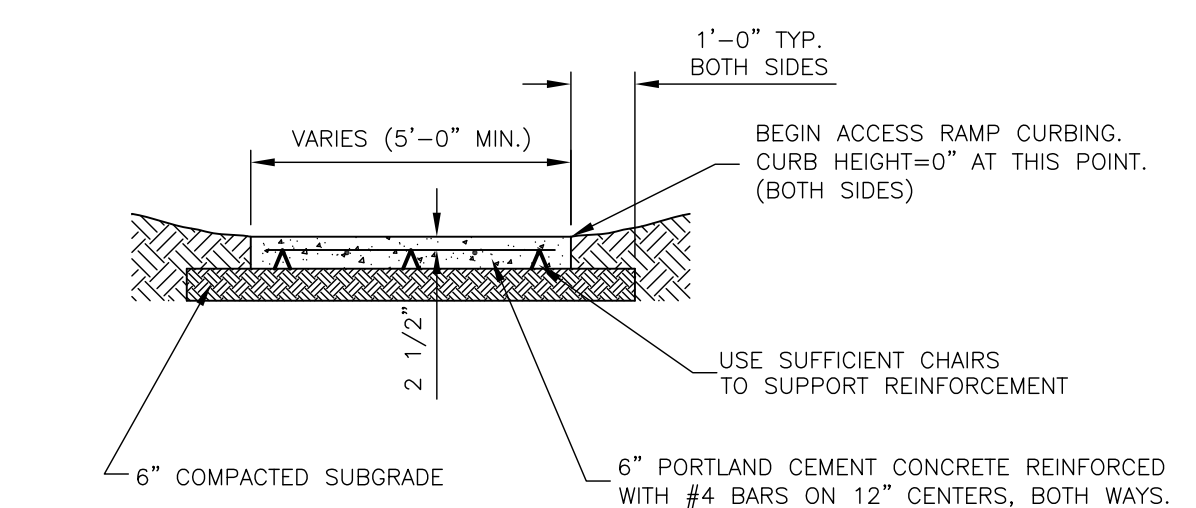

SECTION C-C

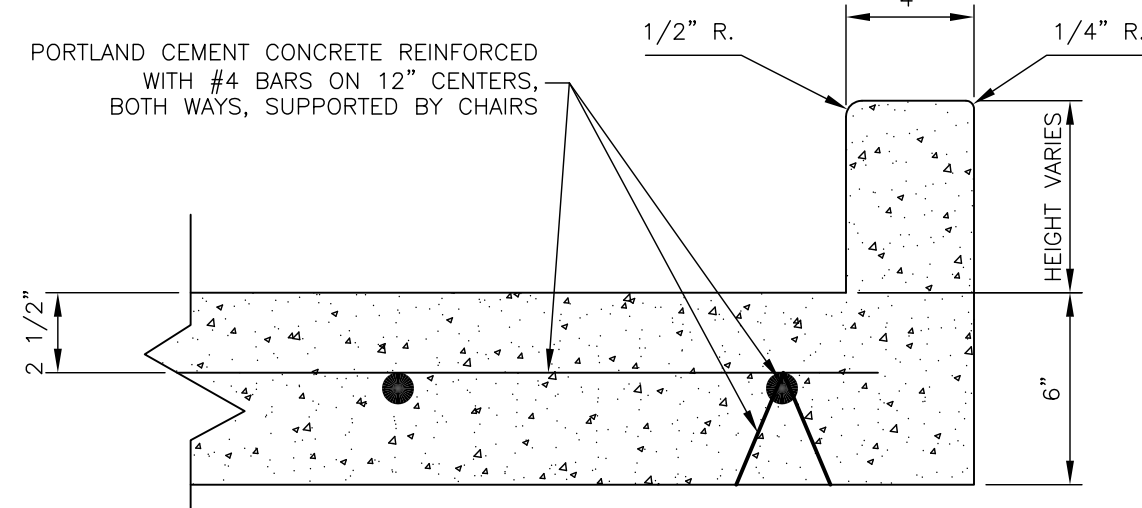

ACCESS RAMP CURB DETAIL

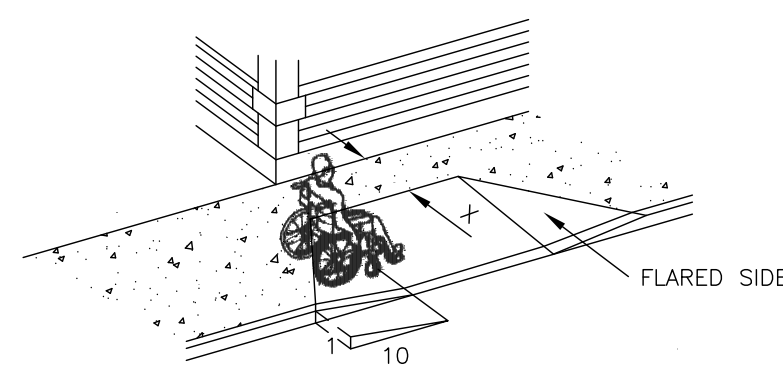

THIS FIGURE SHOWS A TYPICAL CURB RAMP, CUT INTO A WALKWAY PERPENDICULAR TO THE CURB FACE, WITH FLARED SIDES HAVING A MAXIMUM SLOPE OF 1:10. THE LANDING AT THE TOP, MEASURED FROM THE TOP OF THE RAMP TO THE EDGE OF THE WALKWAY OR CLOSEST OBSTRUCTION IS DENOTED AS "X". IF "X" IS THE LANDING DEPTH AT THE TOP OF THE CURB RAMP IS LESS THAN 48", THEN THE SLOPE OF THE FLARED SIDE SHALL NOT EXCEED 1:12.

ACCESS RAMP WITH FLARED SIDES

ACCESS RAMP DETAILS

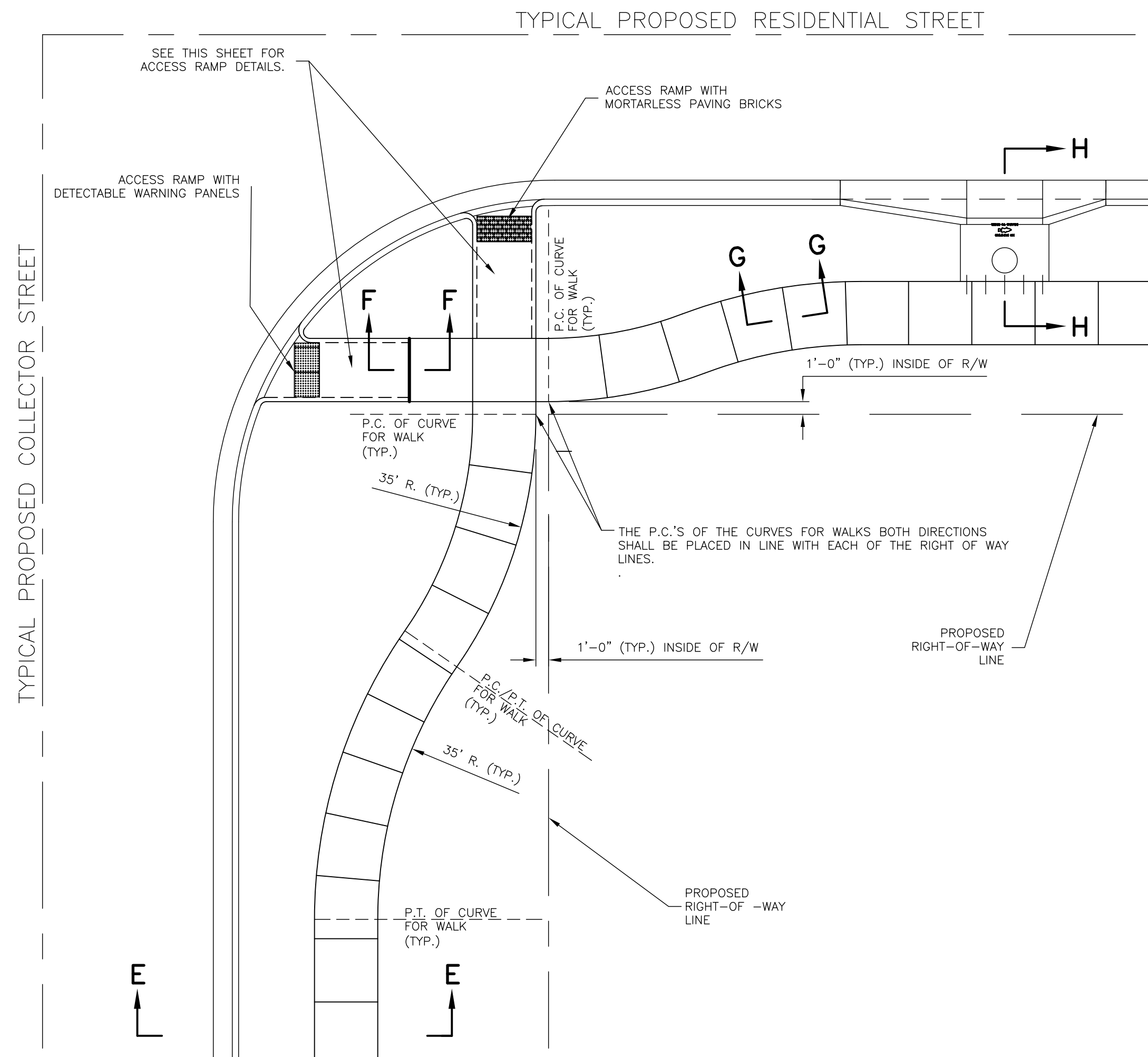

GENERAL SIDEWALK LAYOUT PLAN

SHEET _____ OF _____

DATE	BY	REVISION
12-17-10	LJM	CITY LOGO UPDATED
03-20-08	LJM	REPLACES ALL PREVIOUS VERSIONS OF SIDEWALK DETAILS



STANDARD DETAILS FOR CONCRETE SIDEWALKS

SHOEB M. UDDIN CITY ENGINEER DAVID L. CORLISS CITY MANAGER