



M1

REVISED JUNE 23, 2015

SCALE: Reference Illustrations

VIEWING DISTANCE: Rule of thumb: every 1" of letter height provides 10 feet of readability with the best impact.

MATERIAL: Concrete Foundation, Extruded Aluminum Panels with High Temperature Cured Polyester Color Coating

Letters in lines 1, 2, and 3 are Painted Aluminum. Paint to wrap edges. (Sign fabricator to determine appropriate thickness, no oil canning permitted). Letters in lines 4, 5, 6, and the Address are Applied Vinyl.

*Colors to be selected from manufacturer's standard colors.

*Fabricator to show sample to designer prior to fabrication.

*Address numbers to be confirmed with designer prior to fabrication.

TYPOGRAPHY:

Verdana Regular
ABCDEFGHIJKLMNPOQRSTUVWXYZ

Verdana Bold
ABCDEFGHIJKLMNPOQRSTUVWXYZ

LAWRENCE COLLEGE & CAREER CENTER
PEASLEE TECHNICAL TRAINING CENTER
LAWRENCE WORKFORCE CENTER
HIPER TECHNOLOGY
2910-2920
HASKELL

* Lines 1 and 6 of the text will be added at a later time. The illustration at left (NTS) shows what the sign will look like in the interim. The campus title is yet to be determined.

In bid proposal, call out lines 1 and 6 of text as a separate line item--for future installation.

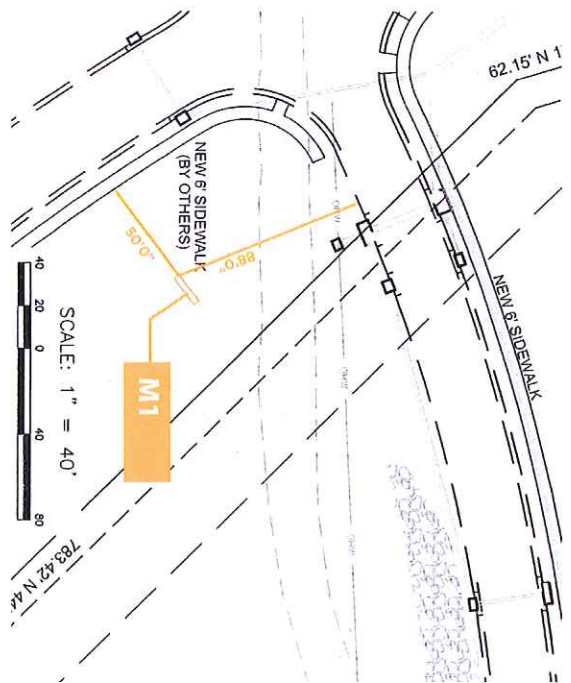

Letter Height for Best Impact	Viewing Distance	Max. Readable Distance
*LINE 1	6"	60'0"
*LINE 2	4"	40'0"
*LINE 3	4"	40'0"
*LINE 4	4"	40'0"
*LINE 5	4"	40'0"
*LINE 6	4"	40'0"
ADDRESS	4"	40'0"
*FUTURE INSTALLATION		
	4"	40'0"

*Possibility of underground utilities near monument location. Before construction begins, contractor to verify location of existing lines.

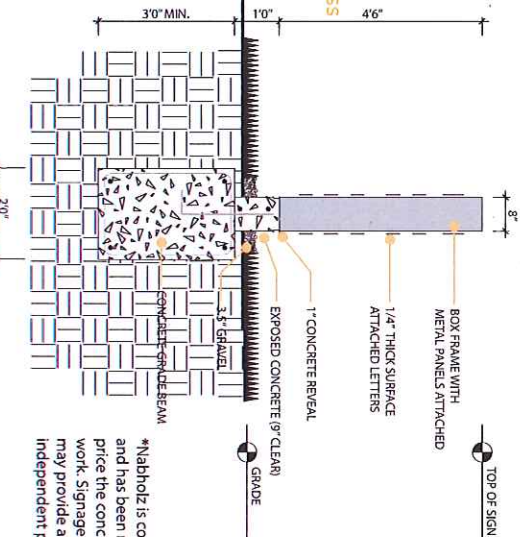
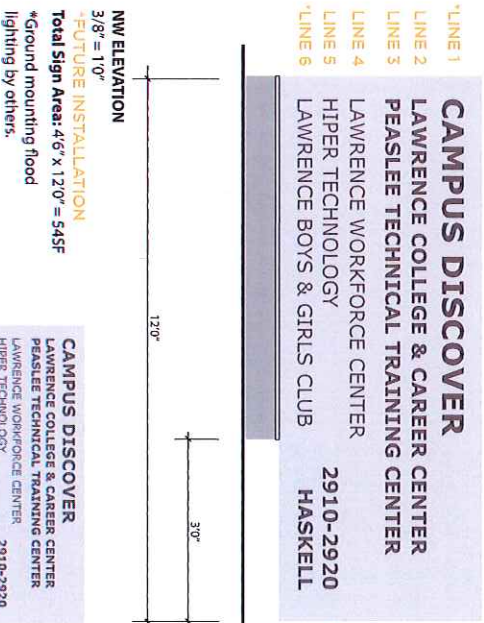

*Nabholz is contractor on site and has been requested to price the concrete foundation work. Signage contractor may provide alternative independent pricing.

SE ELEVATION
NTS