

Drawing Name: W:\Proj\17000\17586\010\AutoCad\Plan Set (rename as needed)\17586_010_SeedFile.dwg Layout Name: Phase Four Plotted By: WDV00942 Plotted on: 6/20/2013 11:10:48 AM
Last edit on: 06/00/00

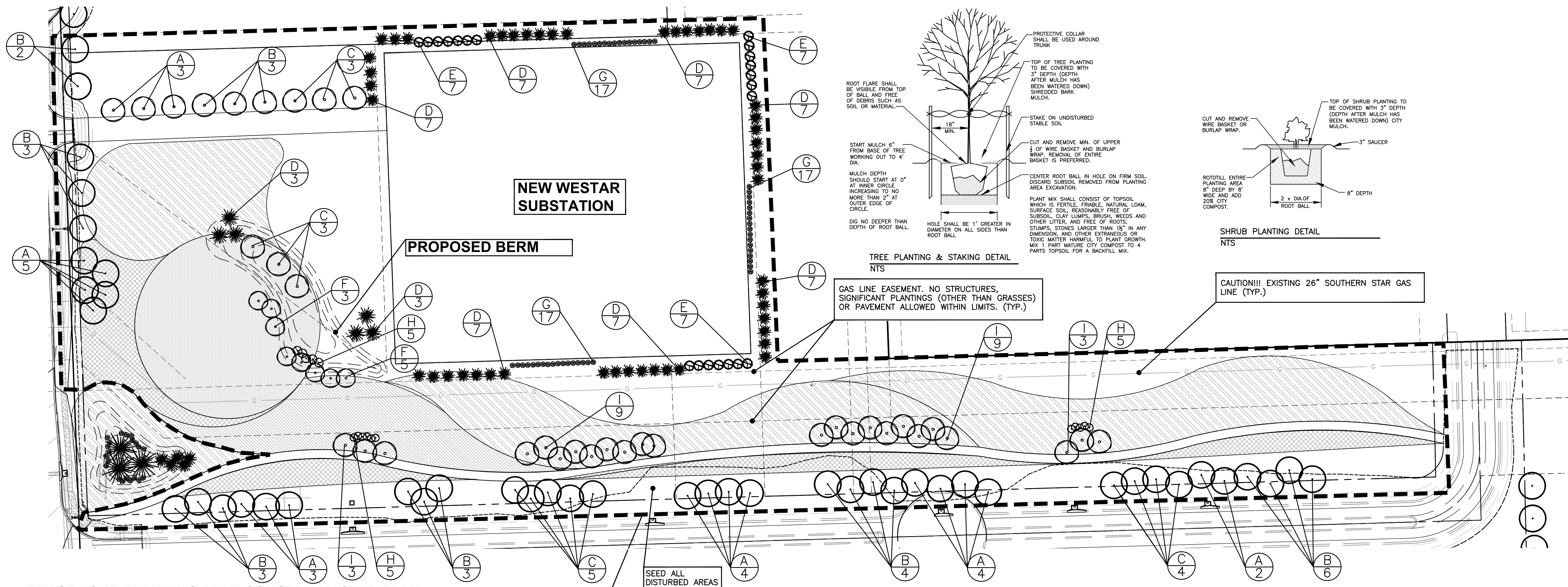

PHASE FOUR PLANTING PLAN CONCEPT MASTER PLAN
1"=60'-0"

PLANTING SCHEDULE FOR NATIVE PLANTINGS:

Key	Common Name	Botanical Name	Qty.
Grasses			
	Big Bluestem	<i>Andropogon gerardii</i>	Use appropriate mix to cover 114,565 s.f. of designated area
	Little Bluestem	<i>Schizachyrium scaparium</i>	
	Indian Grass	<i>Sorghastrum nutans</i>	
	Switchgrass	<i>Panicum virgatum</i>	
	Side-oats grama	<i>Bouteloua curtipendula</i>	
	Tall Dropseed	<i>Sporobolus compositus</i>	
	Junegrass	<i>Koeleria macrantha</i>	
Buffalo Grass Trail			
	Buffalo Grass	<i>Buchloe dactyloides</i>	00 s.f.
Spring Blooms			
	Large Beardtongue	<i>Penstemon grandiflorus</i>	Use appropriate mix to cover 21,443 s.f. of designated area
	Blue Wild Indigo	<i>Baptisia australis</i>	
	Fringeleaf Ruellia	<i>Ruellia humilis</i>	
	Clammy Groundcherry	<i>Physalis heterophylla</i>	
	Prairie Coneflower	<i>Ratibida columnifera</i>	
Summer Blooms			
	Fringeleaf Ruellia	<i>Ruellia humilis</i>	Use appropriate mix to cover 58,972 s.f. of designated area
	Prairie Lespedeza	<i>Lespedeza violacea</i>	
	Western Ironweed	<i>Vernonia baldwinii</i>	
	Lead plant	<i>Amorpha canescens</i>	
	Pitchersage	<i>Salvia azurea</i>	
	Daisy Fleabane	<i>Erigeron strigosus</i>	
	Canada Goldenrod	<i>Solidago canadensis</i>	
	Missouri Goldenrod	<i>Solidago missouriensis</i>	
Autumn Blooms			
	Western Ironweed	<i>Vernonia baldwinii</i>	Use appropriate mix to cover 21,443 s.f. of designated area
	Pitchersage	<i>Salvia azurea</i>	
	Prairie Lespedeza	<i>Lespedeza violacea</i>	
	Canada Goldenrod	<i>Solidago canadensis</i>	
	Missouri Goldenrod	<i>Solidago missouriensis</i>	
	Snow on the Mountain	<i>Euphorbia marginata</i>	
Wildflower Mix			
	Prairie Coneflower	<i>Ratibida columnifera</i>	Use appropriate mix to cover 32,142 s.f. of designated area
	Fringeleaf Ruellia	<i>Ruellia humilis</i>	
	Blue Wild Indigo	<i>Baptisia australis</i>	
	Daisy Fleabane	<i>Erigeron strigosus</i>	
	Canada Goldenrod	<i>Solidago canadensis</i>	
	Missouri Goldenrod	<i>Solidago missouriensis</i>	
	Butterfly Milkweed	<i>Asclepias tuberosa</i>	
	Black Sampson Echinacea	<i>Echinacea angustifolia</i>	
	Indian Blanket Flower	<i>Gaillardia pulchella</i>	

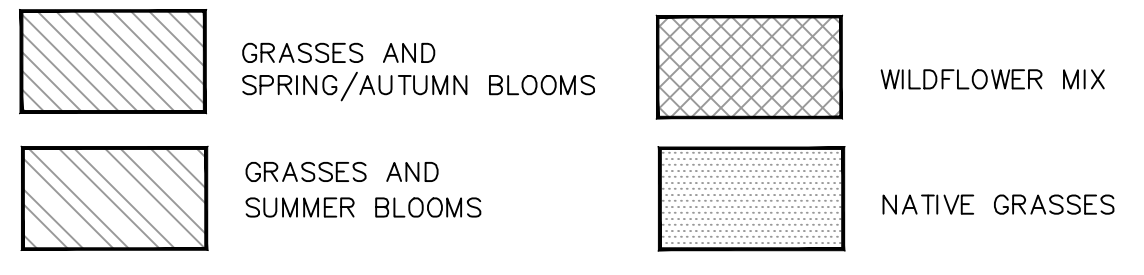

PHASE FOUR PLANT SCHEDULE

Name	Size	Cond.	#
Shade Trees			
A Sawtooth Oak <i>Quercus acutissima</i>	2.5" Cal. Min.	B&B	21
B London Planetree 'Exclamation' <i>Platanus x acerifolia</i> 'Morton Circle'	2.5" Cal. Min.	B&B	24
C Bald Cypress <i>Taxodium distichum</i>	2.5" Cal. Min.	B&B	15
Evergreen Trees			
D Keteleeri Juniper <i>Juniperus chinensis</i> 'Keteleeri'	6' HT. Min.	B&B	55
Large Shrubs/Small Trees			
E Prauge Viburnum <i>Viburnum x pragense</i>	3 Gal. Min. 24" Ht.	CONT.	21
F Oklahoma Redbud <i>Cercis reniformis</i>	2" Cal. Min.	B&B	3
G Double Knockout Rose <i>Rosa 'Radtko'</i>	3 Gal. Min. 24" Ht.	CONT.	51
H Pochahontas Lilac <i>Syringa x hycinthiflora</i> 'Pochahontas'	3 Gal. Min. 24" Ht.	CONT.	15
I White Redbud <i>Cercis canadensis</i> 'Alba'	2" Cal. Min.	B&B	24

LANDSCAPE NOTES:

- GENERAL CONTRACTOR SHALL GUARANTEE ALL PLANT MATERIAL FOR A PERIOD OF ONE (1) YEAR FROM DATE OF PROJECT SUBSTANTIAL COMPLETION.
- ALL PLANT MATERIALS SHALL MEET MINIMUM REQUIREMENTS SHOWN IN THE "AMERICAN STANDARDS FOR NURSERY STOCK" (ANSI 260.1-2004).
- EACH TREE AND SHRUB SHALL BE SECURELY LABELED WITH A WATERPROOF TAG INDICATING BOTANICAL NAME AND COMMON NAME FOR DELIVERY TO SITE.
- NO PLANT MATERIAL SHALL BE SUBSTITUTED WITHOUT THE APPROVAL OF THE OWNER. ALL PLANTING LOCATIONS FOR TREES AND SHRUBS SHALL BE FLAGGED BY THE CONTRACTOR AND APPROVED BY THE OWNER, PRIOR TO INSTALLATION.
- ALL DISCREPANCIES AND/OR FIELD CHANGES SHALL BE REPORTED TO THE OWNER FOR APPROVAL PRIOR TO IMPLEMENTATION. WHEN CONDITIONS DETRIMENTAL TO PLANT GROWTH ARE ENCOUNTERED, SUCH AS RUBBLE FILL, ADVERSE DRAINAGE CONDITIONS OR OBSTRUCTIONS, LANDSCAPE CONTRACTOR SHALL NOTIFY THE OWNER BEFORE PLANTING.
- THE GENERAL CONTRACTOR SHALL VERIFY LOCATION OF AND PROTECT ALL UTILITIES AND STRUCTURES. DAMAGE TO UTILITIES AND STRUCTURES SHALL BE REPAIRED BY THE GENERAL CONTRACTOR TO THE SATISFACTION OF THE OWNER.
- THE LANDSCAPE CONTRACTOR SHALL COORDINATE ALL WORK WITH OTHER CONTRACTORS ON SITE THROUGHOUT THE CONSTRUCTION PROCESS.
- ALL SHRUBS SHALL BE INSTALLED IN PROPOSED PLANTING BEDS AND COVERED WITH SHREDDED BARK MULCH OR ACCEPTABLE MATERIAL APPROVED BY THE OWNER.
- ALL PLANTED SURFACES SHALL RECEIVE EMULSION TYPE, FILM FORMING, ANTI-DESSICANT AGENT DESIGNED TO PERMIT TRANSPIRATION, BUT RETARD EXCESSIVE LOSS OF MOISTURE FROM PLANTS. ANTI-DESSICANT TO BE DELIVERED IN MANUFACTURER'S FULLY IDENTIFIED CONTAINERS AND MIXED IN ACCORDANCE WITH MANUFACTURER'S INSTRUCTIONS. APPLY PRIOR TO APPLICATION OF MULCH.
- ALL DISTURBED AREAS NOT DESIGNATED AS PAVEMENT OR PLANTING BEDS SHALL BE SEEDED ACCORDING TO SPECIFICATIONS PROVIDED BY THE CITY OF LAWRENCE. PLEASE CONTACT CRYSTAL MILES, HORTICULTURE AND FORESTRY MANAGER FOR THE CITY OF LAWRENCE (785) 832-7972 FOR INFORMATION. ALL TURF AREAS SHALL CONSIST OF A MINIMUM 8" THICKNESS TOPSOIL FREE OF CLAY, DEBRIS, STICKS OR ROCKS IN EXCESS OF 1" IN DIAMETER. ALL TOPSOIL AREAS SHALL BE FINE GRADED AND RAKED, REMOVING RIDGES AND FILLING DEPRESSIONS AS REQUIRED TO MEET FINISHED GRADES AND CREATE POSITIVE DRAINAGE AWAY FROM BUILDINGS. PRIOR TO SEEDING OR SODDING, MOISTEN PREPARED TOPSOIL IF GROUND IS DRY. AFTER ONE MONTH FOLLOWING SEEDING OR SODDING, APPLY FERTILIZER AT THE MANUFACTURER'S RECOMMENDED RATE FOR NEWLY ESTABLISHED LAWNS. AFTER TWO MONTHS FOLLOWING SEEDING OR SODDING, APPLY GYPSUM AT THE RATE OF 100 LBS. PER 1000 SQ. FEET. THE GENERAL CONTRACTOR SHALL MAINTAIN ALL PLANTED OR TURF AREAS THROUGHOUT THE WARRANTY PERIOD AND SHALL PERFORM OPERATIONS SUCH AS ROLLING, REGRADING, RESEEDING, RESODDING, AND/OR REPLANTING AS REQUIRED TO ESTABLISH A SMOOTH TURF SURFACE, FREE OF ERODED OR BARE AREAS TO THE SATISFACTION OF THE OWNER.
- ALL UTILITY INFORMATION SHOWN HEREIN IS BASED ON THE INFORMATION AVAILABLE TO THE DESIGNER AT THE TIME OF DESIGN. THE CONTRACTOR SHALL VERIFY ALL UTILITY DEPTHS AND LOCATIONS PRIOR TO CONSTRUCTION. THE CONTRACTOR SHALL BE RESPONSIBLE FOR CONTACTING ALL UTILITY COMPANIES TO FIELD LOCATE AND/OR ADJUST THEIR UTILITY AS REQUIRED FOR CONSTRUCTION. ALL UTILITY LOCATIONS SHOWN ON THE PLANS ARE APPROXIMATE AND THE ENGINEER ASSUMES NO LIABILITY FOR SAME.
- CONTRACTOR SHALL BE RESPONSIBLE FOR CALCULATING THE AREAS AND QUANTITIES OF SEED NEEDED FOR OPTIMUM COVERAGE.
- ALL EDGING IS A NATURAL EARTH EDGE AS SHOWN, CONSTRUCTED WITH A SHARPSHOOTER OR OTHER SUITABLE IMPLEMENT. LINES AND CURVES SHALL BE CONTINUOUS AND SMOOTH, MEETING THE DESIGN INTENT SHOWN ON THE DRAWINGS.
- REMOVE ANY EXCESS SOIL AND DEBRIS FROM AREA AND DISPOSE OF IN AN APPROVED MANNER.
- SPACING SHOWN FOR PLANTS IS FOR INFORMATION ONLY AND SHALL BE ADJUSTED AS REQUIRED TO PROVIDE UNIFORM SPACING WITHIN PLANTING BEDS.
- IRRIGATION WILL BE PROVIDED IN ALL LANDSCAPED AND NEWLY SODDED AREAS. LANDSCAPE CONTRACTOR SHALL BE RESPONSIBLE TO SUBMIT IRRIGATION PLANS TO THE CITY OF LAWRENCE PRIOR TO INSTALLATION. IRRIGATION DESIGN TO BE DETERMINED BY LANDSCAPE CONTRACTOR. WATERLINE ACCESS TO BE PROVIDED FROM EASTERN EXTENSION AS INDICATED ON PLANS.
- CITY WILL PROVIDE MULCH FOR ALL LANDSCAPED AREAS.

NOTE: ALL PLANTINGS NEED TO BE REVIEWED AND COORDINATED WITH WESTAR ENERGY REPRESENTATIVE PRIOR TO APPROVAL OR INSTALLATION (TYP.)

PHASE FOUR