

NOTE:
 9TH STREET CLOSURE TO OCCUR DURING THE PERIOD OF MAY 26TH TO JUNE 7TH FOR A TIME NOT TO EXCEED NINE CONSECUTIVE DAYS.

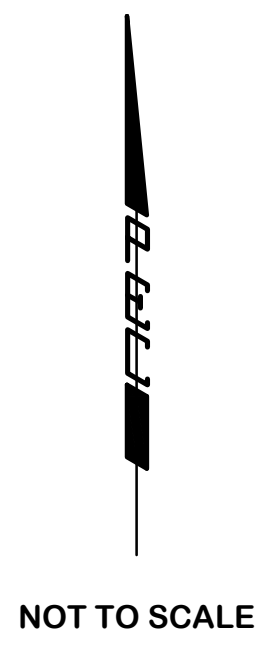
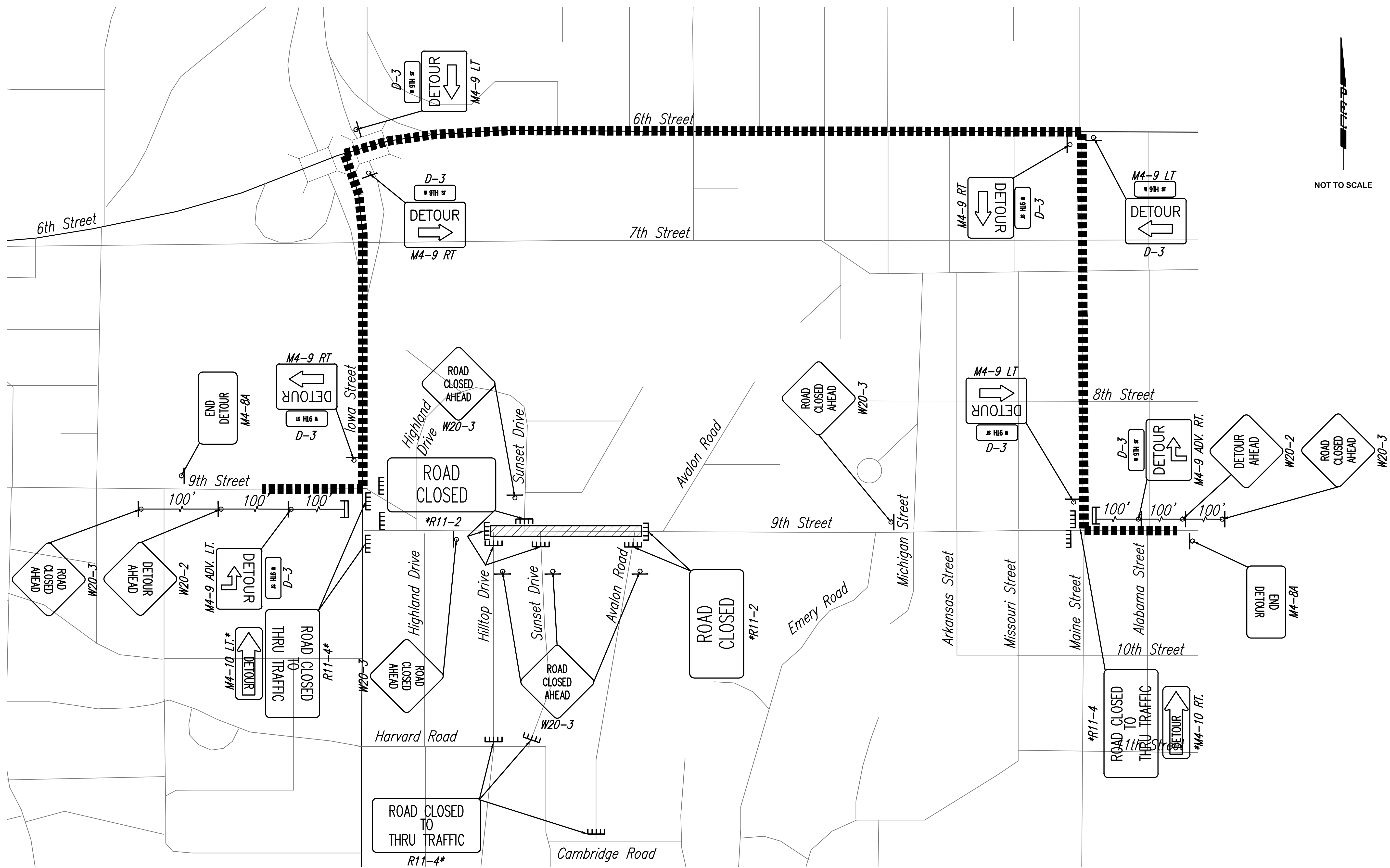

9TH ST
 CLOSED
 5/26-6/7

CLOSED AT
 HILLTOP
 TO AVALON

VARIABLE MESSAGE BOARD

- LEGEND**
- WORK ZONE
 - 9TH STREET DETOUR
 - VARIABLE MESSAGE BOARD
 - SIGN
 - TYPE III BARRICADES
 - MOUNT ON TYPE III BARRICADES

Saved: 03-03-2015 3:22:11 PM by BRANLIDRETH
 Plot Scale: 1" = 100'-00" (03-03-2015 3:25:46 PM by BRANLIDRETH)
 C:\Users\BCH\Documents\2014\2015 Watermain Relocation\Drawings\14401-002-3975-9TH STREET DETOUR

No.	Revision	By	Date
	CITY OF LAWRENCE 2014 - 2015 WATERMAIN RELOCATION PROGRAM AVALON ROAD WATERLINE REPLACEMENT		
9TH STREET DETOUR			
		PROFESSIONAL ENGINEERING CONSULTANTS, P.A. 616 VERMONT ST., STE B. LAWRENCE, KS 66044 785-842-8464 www.pec1.com	
Designed by	JLF	Job No.	14A01-002-3975
Drawn by	BCH	Date	JANUARY 2015
			Sht.