



-  KU accessible area
-  public controlled area – no access
-  public controlled line – no access to rec. center or parking



Approved and Released

City of Lawrence
Douglas County

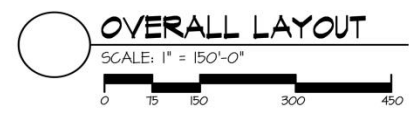
Case No. _____
Approval Date: _____
Release Date: _____
Planner: _____ of _____ Sheets
Asst./Director: _____

Civil Engineering
Landscape Architecture
Community Planning
Surveying

1310 Wakarusa Drive
Lawrence, Kansas 66049
tele (785)843-7530
fax (785)843-2410
email landplan@aol.com



Landplan Engineering, P.A.

paulwerner
ARCHITECTS
123 W. 8TH STREET
SUITE B2
LAWRENCE, KS 66044
OFFICE: 785.832.0804
FAX: 785.832.0890

goulddevans

706 Massachusetts St.
Lawrence, KS 66044
P: 785-830-7064
F: 785-842-3830

OWNER:
RCP, LLC.
PO BOX 828
LAWRENCE, KS 66044

PAUL WERNER ARCHITECTS, L.L.C.
THIS DRAWING IS COPYRIGHTED WORK BY
PAUL WERNER ARCHITECTS, L.L.C. THIS
DRAWING MAY NOT BE REPRODUCED,
TRACED OR COPIED IN ANY MANNER
WITHOUT THE WRITTEN PERMISSION OF PAUL
WERNER ARCHITECTS, L.L.C.

**ROCK CHALK PARK
SPECIAL USE PERMIT**

GEORGE WILLIAMS WAY
LAWRENCE, KANSAS

PROJECT # 212-140

RELEASE: 2.0 DATE: 7.31.13
2.1 10.9.13

SUP-2

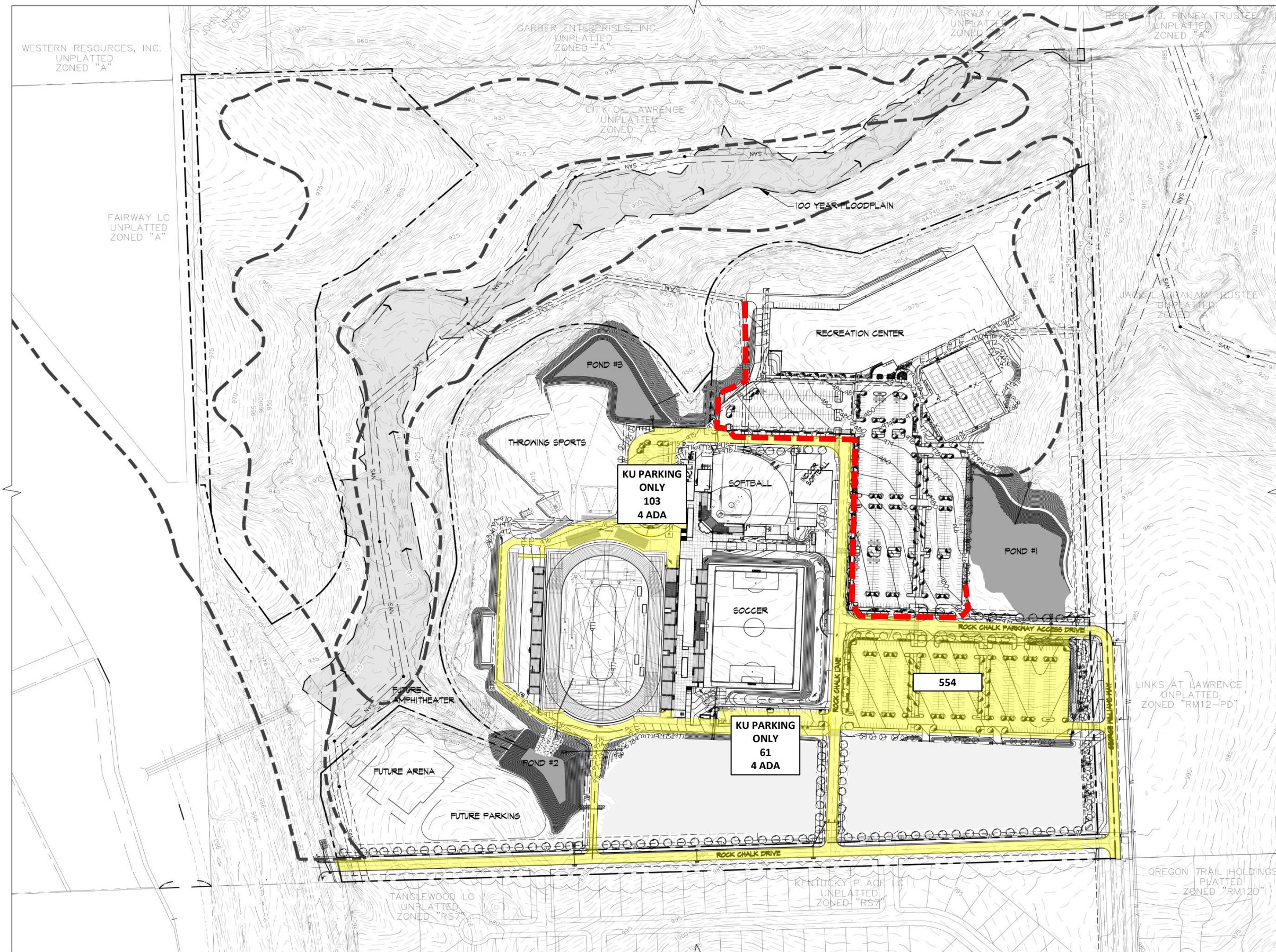

- roads & parking
- public controlled line – no access to rec. center

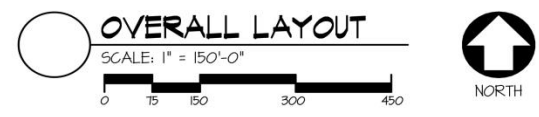

Approved and Released

City of Lawrence
Douglas County

Case No. _____
Approval Date: _____
Release Date: _____
Planner: _____ of _____ Sheets
Asst./Director: _____

Civil Engineering
Landscape Architecture
Community Planning
Surveying

1310 Wakarusa Drive
Lawrence, Kansas 66049
tele (785)843-7530
fax (785)843-2410
email landplan@aol.com



Landplan Engineering, P.A.

paulwerner
ARCHITECTS
123 W. 8TH STREET
SUITE B2
LAURENCE, KS 66044
OFFICE: 785.832.0804
FAX: 785.832.0890

gouldevans

706 Massachusetts St.
Lawrence, KS 66044
P: 785-830-7064
F: 785-842-3830

OWNER:
RCP, LLC.
PO BOX 928
LAURENCE, KS 66044

PAUL WERNER ARCHITECTS, L.L.C.
THIS DRAWING IS COPYRIGHTED WORK BY
PAUL WERNER ARCHITECTS, L.L.C. THIS
DRAWING MAY NOT BE REPRODUCED,
TRACED OR COPIED IN ANY MANNER
WITHOUT THE WRITTEN PERMISSION OF PAUL
WERNER ARCHITECTS, L.L.C.

**ROCK CHALK PARK
SPECIAL USE PERMIT**

GEORGE WILLIAMS WAY
LAURENCE, KANSAS

PROJECT # 212-140

RELEASE: 2.0 DATE: 7.31.13
2.1 10.9.13

SUP-2