

AGENDA: TSC 11/4/13

ITEM NO. 7: Consider request for TRAFFIC CALMING on Lawrence Avenue between 27th Street & 31st Street.

Staff Report:

1. Lawrence Avenue is classified as a "collector" in a residential area with a speed limit of 30 mph.
2. Traffic data collected September 19-20 found approximately 1850 vehicles in a 24-hour period and an 85th percentile speed of approximately 31.8mph.
3. In addition, approximately 58% of the frontage along the roadway consists of residential lots with the houses facing Lawrence Avenue.

MINUTES: TSC 11/4/13

ITEM NO. 7:

Consider request for TRAFFIC CALMING on Lawrence Avenue between 27th Street & 31st Street.

Woosley reviewed the information provided in the staff report.

Public Comment:

None.

Commission Discussion:

Commissioner Ziegelmeyer: We asked that this come back as a traffic calming request.

Commissioner Rothrock: We thought it fit a lot better with traffic calming than it did with a speed limit reduction.

MOTION BY COMMISSIONER HARDEN, SECOND BY COMMISSIONER ROTHROCK TO RECOMMEND TRAFFIC CALMING ON LAWRENCE AVENUE BETWEEN 27TH STREET & 31ST STREET; THE MOTION CARRIED, 8-0.

From: Cole, Maureen [mailto:maurole@ku.edu]
Sent: Monday, October 14, 2013 1:08 PM
To: David Woosley
Subject: request for traffic calming on Lawrence Avenue

Good Morning,

I would like to change my request to have the traffic safety commission consider traffic calming measures on Lawrence Avenue between 23rd and 31st streets based upon the reasons stated in my initial email (which I have included below).

Many thanks for all of your help!

Maureen

From: Cole, Maureen [mailto:maurole@ku.edu]
Sent: Tuesday, June 11, 2013 1:13 PM
To: David Woosley
Subject: Lowering Speed Limit on South End of Lawrence Avenue

Hello,

I live at 28th and Lawrence Avenue, and today there was a collision in front of my house with one car ending up in our front yard. Recently, I have noticed an increase people speeding along Lawrence Avenue. After my brother-in-law was almost plowed into pulling out of our driveway, two weeks ago, I thought it might be good to look into getting the speed limit lowered to 25 miles per hour in our neighborhood or at least on Lawrence Avenue. This was a day after our neighbor's dog got hit by a car in broad daylight, there weren't any cars parked along the sides of the street that that time and so it's not like the dog darted out all of a sudden, the car was just going too fast to stop. Luckily, the dog was okay and thankfully it wasn't a child that ran out.

With today's accident, I am now convinced that we need to have the speed limit lowered. How does one go about getting that done?

Many thanks!

Maureen

*Maureen Cole
Administrative Assistant
CLAS Dean's Office
Strong Hall, Rm 200
The University of Kansas
Ph: (785) 864-3681*



TRAFFIC CALMING POLICY

Resolution No. 6602, August 23, 2005

1. TRAFFIC-CALMING DEVICES may include but are not limited to Traffic-Calming Circles, Speed Humps and Speed Cushions, Speed Tables, Partial Diverters, Full Diverters, Center Island Narrowing, Chokers, and Road Closures; however, roundabouts are traffic management devices and are not subject to this policy.
2. TRAFFIC-CALMING DEVICES may be permitted on "local" streets as designated by the City's Major Thoroughfares Map, and under any one of the following conditions:
 - A. The 85th percentile speed of traffic is 5 mph or greater over the speed limit, or
 - B. The 24-hour two-way traffic volume is greater than 1000, or
 - C. Cut-through traffic comprises more than 50% of the traffic during the peak hour of the day, or
 - D. Where no single condition is satisfied, but where any two of A, B or C above are satisfied to the extent of 80 percent or more of the stated values.
3. TRAFFIC-CALMING DEVICES (except SPEED HUMPS) may be permitted on "collector" streets as designated by the City's Major Thoroughfares Map, under any one of the following conditions:
 - A. The 85th percentile speed of traffic is 5 mph or greater over the speed limit, or
 - B. The 24-hour two-way traffic volume is greater than 3000, or
 - C. Cut-through traffic comprises more than 50% of the traffic during the peak hour of the day, or
 - D. More than 50% of the frontage of the roadway consists of residential lots with the houses facing the roadway in question, or
 - E. Where no single condition is satisfied, but where any two of A, B, C or D above are satisfied to the extent of 80 percent or more of the stated values.
4. Traffic data will be collected with city personnel using city equipment only. In the event that a requested location does not meet the minimum requirements as stated in 2 or 3 above, subsequent requests will not be considered for a minimum of one year.
5. The Lawrence-Douglas County Fire & Medical Department, the Police Department, the Public Works Department and the Traffic Safety Commission must review all requests for TRAFFIC-CALMING DEVICES before being presented to the City Commission.
6. If a project is approved by the City Commission, the City Commission will determine financing of the construction. The City Commission may require 0-100% of the costs to be paid by the group or neighborhood making the request.
7. After a project is approved and funded by the City Commission, TRAFFIC-CALMING DEVICES will only be constructed at a location if 70% or more of the property owners within 300 feet measured along the centerline of the street in each direction approve of the installation or if directed by the City Commission. The individual, group or neighborhood making the request shall be responsible for obtaining the property owners' and residents' approval in writing and submitting it to the city.
8. Once installed, TRAFFIC-CALMING DEVICES may only be removed at a location if more than 70% of the property owners and residents within 300 feet measured along the centerline of the street in each direction approve of the removal or if directed by the City Commission. The individual, group or neighborhood making the request shall be responsible for obtaining the property owners' and residents' approval in writing and submitting it to the city.
9. TRAFFIC CALMING DEVICES may initially be landscaped (if appropriate) by the city, provided that the group or neighborhood making the request agrees in writing to maintain the landscaping or pursuant to the payment of a landscape maintenance fee. No privately installed landscaping is permitted unless approved by the city in writing.

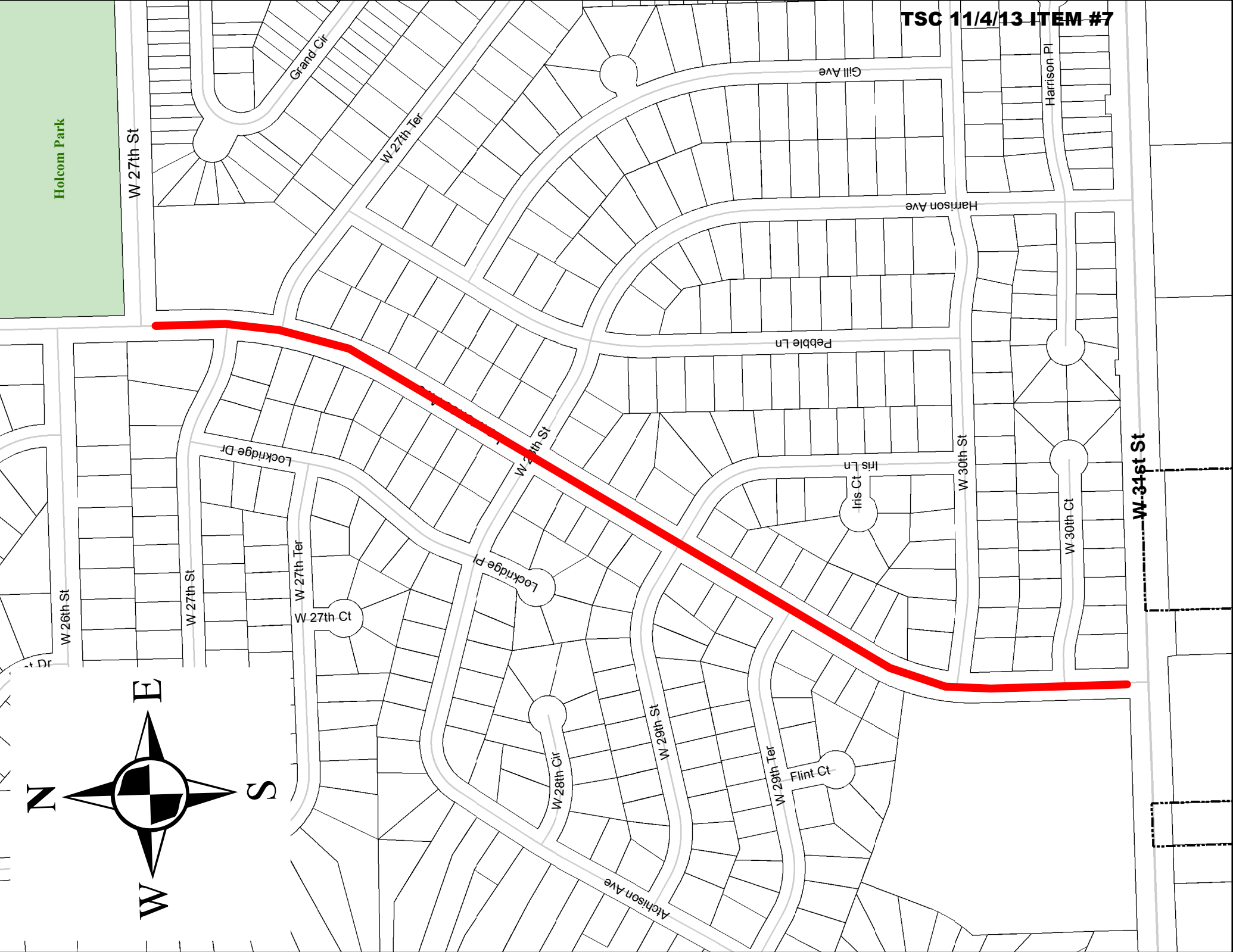

Holcom Park

W 27th St

Grand Cir

W 27th Ter

Gill Ave

Harrison Pl

Harrison Ave

Pebble Ln

W 28th St

Lockridge Dr

W 27th Ter

W 27th Ct

Lockridge Pl

W 28th Cir

W 29th St

W 29th Ter

Flint Ct

W 30th St

W 30th Ct

W 34th St

