

LOCATION MAP:

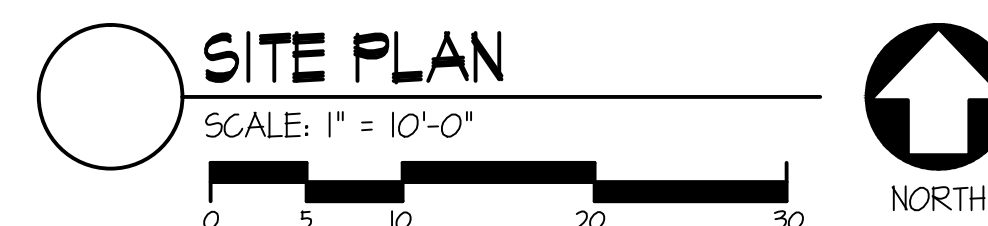
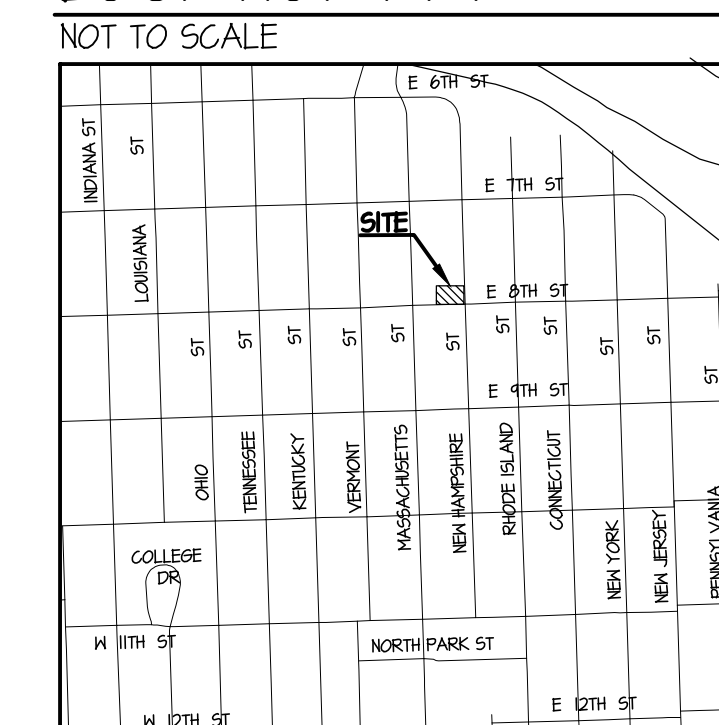

GENERAL NOTES:

- 1.1 LEGAL DESCRIPTION : NEW HAMPSHIRE STREET, SOUTH 44 FEET 5 INCHES, LOT 41 & ALL LOT 43 ADDRESS : 124 NEW HAMPSHIRE STREET
- 1.2 CURRENT ZONING / USE : CD
- 1.3 LAND AREA : .264 ACRES
- 1.4 PROPOSED PROJECT : SIDEWALK DINING AREA
- 1.5 PARKING REQUIRED : EXEMPT
- 1.6 DUMPSTER : EXISTING (IN ALLEY)
- 1.7 PLAN FOR CITY APPROVAL, NOT FOR CONSTRUCTION.
- 1.8 PROPERTY WILL NOT BE REPLATTED
- 1.9 EXISTING GROSS SQUARE FOOTAGE: MAIN FLOOR: 11,445 SQ. FT.
- 1.10 SIDEWALK HOSPITALITY LICENSE TO BE OBTAINED UPON FINAL APPROVAL OF THE PLAN.
- 1.11 PER CITY CODE SECTION 9-402, THE OUTDOOR DINING AREA WILL BE MANAGED TO PREVENT STORM WATER POLLUTION. FOOD WASTE, TRASH, CIGARETTES AND OTHER SOLID WASTES WILL BE COLLECTED AND DISPOSED OF PROPERLY. FLUID WASTE INCLUDING WASTEWATER FROM PAVEMENT OR FURNITURE CLEANING, WILL BE COLLECTED AND DISCHARGED TO THE SANITARY SEWER SYSTEM.
- 1.12 NO ADDITIONAL EXTERIOR LIGHTING WILL BE INSTALLED.
- 1.13 RAILING SHALL NOT BE ATTACHED TO THE BUILDING.
- 1.14 INFORMATION TAKEN FROM AERIAL PHOTOS, ONSITE INSPECTION, AND CITY UTILITY MAPS.
- 1.15 SITE PLAN HAS BEEN DESIGNED TO COMPLY WITH THE PROVISIONS OF THE AMERICANS WITH DISABILITIES ACT ACCESSIBILITY GUIDELINES (ADAAG) FOR BUILDINGS AND FACILITIES, APPENDIX A TO 28CFR PART 36.
- 1.16 HOSPITALITY RIGHT-OF-WAY LEGAL DESCRIPTION: START AT SOUTHEAST PROPERTY LINE CORNER, 15 FEET SOUTH, SOUTH 5.24 FEET 45" WEST, 30.61 FEET WEST, WEST 6 FEET 45" NORTH, 15 FEET NORTH, 38.60 FEET EAST 1" SOUTH.

LANDSCAPING:

- 2.1 NO ADDITIONAL LANDSCAPING IS PROPOSED.

PARKING INFORMATION:

- 3.1 PARKING REQUIRED: CD ZONING EXEMPT PER CITY CODE SECTION 20-401(f).

ENFORCEMENT COMPLIANCE CRITERIA:

TWO TIMES EACH YEAR, THE CODES ENFORCEMENT DIVISION WILL VISUALLY INSPECT THE LOCATION OF EACH LICENSED SIDEWALK DINING LICENSEE AND INSPECT THE SIDEWALK DINING AREA. THE CODES ENFORCEMENT DIVISION WILL VERIFY THE LICENSEE IS OPERATING THE SIDEWALK DINING AREA CONSISTENT WITH THE SITE PLAN AND CONDITIONS, USE OF RIGHT OF WAY AGREEMENT; ALL APPLICABLE CITY CODE PROVISIONS; AND GUIDELINES FOR SIDEWALK DINING AREAS. SPECIFICALLY, THE CODES ENFORCEMENT DIVISION WILL VERIFY:

1. THE SIDEWALK DINING AREA IS NOT BEING USED WHEN THE RESTAURANT OR FOOD SERVICE ESTABLISHMENT IS CLOSED.
2. ADVERTISING SIGNAGE IS NOT PRESENT IN THE SIDEWALK DINING AREA EXCEPT FOR THE NAME OF THE ESTABLISHMENT ON CHAIRS OR TABLES AS APPROVED BY THE CITY, OR AS OTHERWISE PERMITTED BY CITY CODE.
3. ALL AMENITIES INCLUDING RAILINGS, BARRIERS, CHAIRS, AND TABLES ARE MAINTAINED IN GOOD CONDITION.
4. SIX FEET OF UNOBSTRUCTED PEDESTRIAN CLEARANCE IS MAINTAINED BETWEEN THE PERIMETER FENCE AND CURB, TREE, OR ANY OTHER IMPROVEMENT IN THE RIGHT-OF-WAY.
5. ANY AND ALL UMBRELLAS ARE MAINTAINED AT A HEIGHT NO LESS THAN 80 INCHES FROM THE SIDEWALK SURFACE TO THE LOWEST PART OF THE UMBRELLA'S OPENED CANOPY.
6. ANY AMPLIFIED MUSIC OR SOUND COMPLIES WITH THE CITY'S NOISE ORDINANCE.
7. THERE IS NO BLOCKAGE OF BUILDING ENTRANCES OR EXITS IN THE SIDEWALK DINING AREA.
8. THE SIDEWALK DINING AREA; THE AREA FROM THE FRONT BUILDING FACADE TO THE CURB LINE; AND FIVE FEET ALONG THE ADJACENT SIDEWALK TO BOTH SIDES OF THE SIDEWALK DINING AREA, CONTAIN NO TRASH.
9. NO TRASH OR REFUSE STORAGE CONTAINERS ARE IN THE SIDEWALK DINING AREA OR ON ADJACENT SIDEWALK AREAS.
10. PURSUANT TO SECTION 9-402 OF THE CITY CODE, SIDEWALK DINING AREAS MUST BE MANAGED TO PREVENT STORMWATER POLLUTION.
11. FOOD WASTE, TRASH, CIGARETTES AND OTHER SOLID WASTES MUST BE CONTAINED, COLLECTED, AND DISPOSED PROPERLY. COLLECTION MUST BE FREQUENT ENOUGH TO PREVENT WASTES CARRIED OFF BY WIND OR STORMWATER RUNOFF.
12. WASTEWATER FROM THE CLEANING OF PAVEMENT, BUILDINGS, FURNITURE OR OTHER OUTDOOR SURFACES MUST BE COLLECTED AND DISCHARGED TO THE SANITARY SEWER SYSTEM OR OTHER APPROVED WASTEWATER TREATMENT PROCESS. INSTALLATION OF A NEARBY SANITARY SEWER CLEANOUT IS RECOMMENDED FOR THIS PURPOSE.
13. PAVEMENT AND FURNISHINGS MUST BE CLEANED FREQUENTLY ENOUGH TO PREVENT CONTAMINATION OF STORMWATER RUNOFF.
14. FOOD PREPARATION IS NOT PERMITTED WITHIN SIDEWALK DINING AREAS.
15. IF THE ESTABLISHMENT NO LONGER HAS A CURRENT SIDEWALK DINING LICENSE, THE CODES ENFORCEMENT DIVISION WILL CONTACT THE FORMER LICENSEE OR OWNER OF THE PREMISES TO REQUIRE REMOVAL OF THE RAILING OR OTHER AMENITIES (CHAIRS, TABLES, ETC.) REMAINING IN THE RIGHT OF WAY.

FOR SIDEWALK DINING LICENSEES WITH A VALID DRINKING ESTABLISHMENT LICENSE OR CEREAL MALT BEVERAGE LICENSE AND CITY COMMISSION APPROVAL TO SELL, AND ITS PATRONS TO POSSESS AND CONSUME ALCOHOLIC BEVERAGES OR CEREAL MALT BEVERAGES IN THE PUBLIC RIGHT OF WAY, THE CODES ENFORCEMENT DIVISION WILL INSPECT THE SIDEWALK DINING AREA TO ENSURE COMPLIANCE WITH THE FOLLOWING:

1. POSSESSION AND CONSUMPTION OF ALCOHOL IN THE SIDEWALK DINING AREA IS LIMITED TO PATRONS SEATED AT TABLES.
2. AN EMPLOYEE OF THE LICENSEE IS WORKING IN THE SIDEWALK DINING AREA, OR OTHERWISE ABLE TO MONITOR THE SIDEWALK DINING AREA, TO PREVENT ALCOHOLIC BEVERAGES OR CEREAL MALT BEVERAGES FROM LEAVING THE LICENSED PREMISES AND TO ENSURE COMPLIANCE WITH OTHER ALCOHOL RELATED PROVISIONS.
3. ALL ALCOHOLIC BEVERAGES OR CEREAL MALT BEVERAGES CONSUMED IN THE SIDEWALK DINING AREA ARE IN THE APPROPRIATE CONTAINERS (NO GLASSES, CANS OR BOTTLES) UNLESS THE ESTABLISHMENT DEMONSTRATES IT MEETS THE 55% FOOD SALES REQUIREMENT.
4. NO TAPS, KEGS, COOLERS, OR OTHER ALCOHOLIC BEVERAGE OR CEREAL MALT BEVERAGE STORAGE DEVICES ARE USED IN THE SIDEWALK DINING AREA.

IMPERVIOUS SURFACE TABLE:

PROJECT SITE: 11,700 SQ. FT. = .264 AC.

EXISTING CONDITIONS:	PROPOSED CONDITIONS:
BUILDING FOOTPRINT: 11,445 SQ. FT.	BUILDING FOOTPRINT: 11,445 SQ. FT.
PAVEMENT AREA: 255 SQ. FT.	PAVEMENT AREA: 255 SQ. FT.
TOTAL IMPERVIOUS: 11,700 SQ. FT.	TOTAL IMPERVIOUS: 11,700 SQ. FT.
TOTAL PERVIOUS: 0 SQ. FT.	TOTAL PERVIOUS: 0 SQ. FT.

HRC SUBMITTAL DR---

41

Approved and Released

Case No. _____
Approval Date: _____
Release Date: _____
Planner: _____
of _____ Sheets
City of Lawrence
Douglas County
Asst./Director: _____

paulwerner
ARCHITECTS

123 W 8TH STREET
SUITE B2
LAWRENCE, KS 66044
OFFICE: 785.832.0804
FAX: 785.832.0890

**745 NEW HAMPSHIRE
SIDEWALK DINING AREA**
129 NEW HAMPSHIRE
LAWRENCE, KANSAS

PROJECT # 213-140

RELEASE: DATE:
1.0 4.19.13
1.1 10.17.13
1.2 11.05.13

© PAUL WERNER ARCHITECTS, L.L.C.
THIS DRAWING IS COPYRIGHTED WORK BY
PAUL WERNER ARCHITECTS, L.L.C. THIS
DRAWING MAY NOT BE REPRODUCED,
TRACED OR COPIED IN ANY MANNER
WITHOUT THE WRITTEN PERMISSION OF PAUL
WERNER ARCHITECTS, L.L.C.



SOUTH ELEVATION
SCALE: NTS



EAST ELEVATION
SCALE: NTS

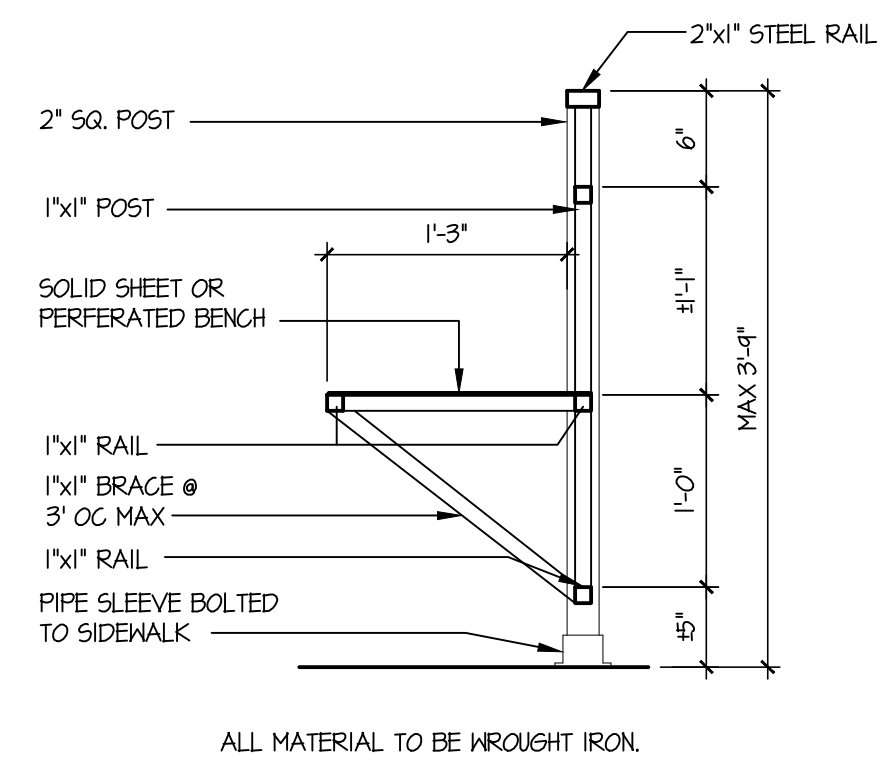

SECTION THROUGH RAILING
SCALE: 1" = 1'-0"

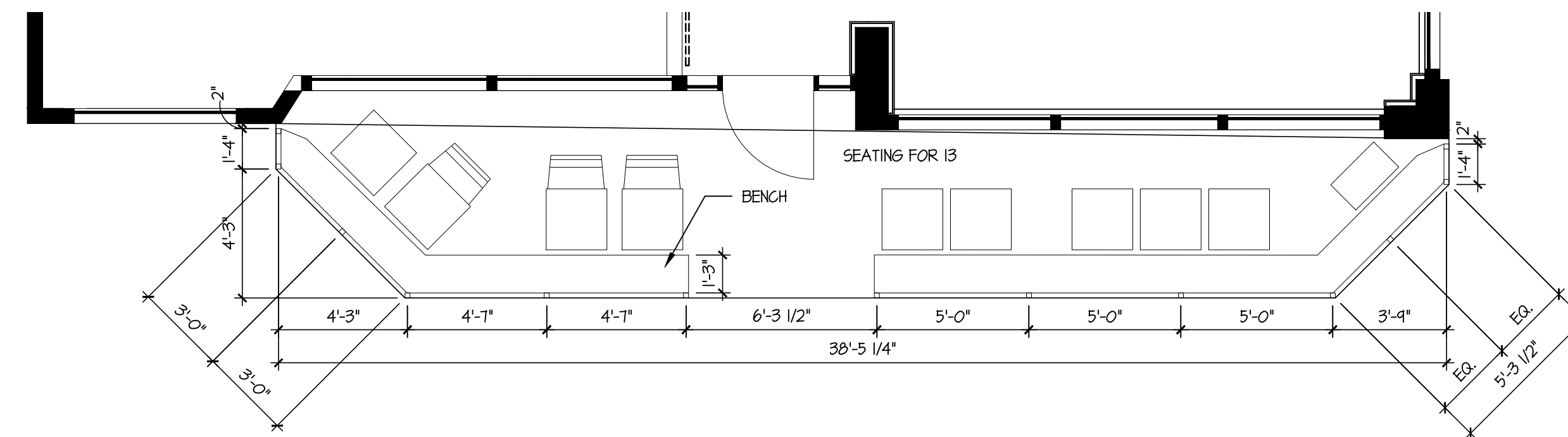

ENLARGED PLAN OF DINING AREA
SCALE: 1/4" = 1'-0"

Approved and Released

Case No. _____
Approval Date: _____
Release Date: _____
Planner: _____
_____ of _____ Sheets
City of Lawrence
Douglas County
Asst./Director: _____

paulwerner
ARCHITECTS

123 W. 8TH STREET
SUITE B2
LAWRENCE, KS 66044
OFFICE: 785.832.0804
FAX: 785.832.0890

© PAUL WERNER ARCHITECTS, L.L.C.
THIS DRAWING IS COPYRIGHTED WORK BY
PAUL WERNER ARCHITECTS, L.L.C. THIS
DRAWING MAY NOT BE PHOTOGRAPHED,
TRACED OR COPIED IN ANY MANNER
WITHOUT THE WRITTEN PERMISSION OF PAUL
WERNER ARCHITECTS, L.L.C.

745 NEW HAMPSHIRE
SIDEWALK DINING AREA
LAWRENCE, KANSAS

PROJECT # 213-740

RELEASE:	DATE:
1.0	9.19.13
1.1	10.17.13
1.2	11.05.13