

INDEX OF SHEETS

1. Title Sheet
2. Summary Of Quantities/Traffic Control Narrative
- 3.-7. Typical Sections with Milling and Overlay Details
- 8.-12. Milling and Overlay Plan Sheets
13. Summary of Surfacing Quantities
- 14.-18. Pavement Marking Plan Sheets
19. Summary and Recapitulation of Pavement Marking Quantities
- 20.-23. Concrete Curb And Gutter Removal And Replacement Plan Sheets
24. Video Detection System Installation On Existing Traffic Signals
- 25.-31. 6th And Kasold Eastbound Right Turn Lane Improvements
- 32.-35. 6th Street Pavement Widening, West Of Iowa Street
- 36.-39. Bus Turnout On 6th Street, West Of Schwarz Road
- 40.-47. Traffic Control Standards
48. Standard Pavement Marking Details
49. Standard Concrete Street Details
50. Standard Concrete Curb And Gutter Details
- 51.-52. Standard Storm Sewer Details
53. Standard Concrete Sidewalk Details
- 54.-56. Traffic Signal Specifications
- 57.-58. Standard Water Line Details
59. Miscellaneous Details

STATE OF KANSAS
DEPARTMENT OF TRANSPORTATION
KLINK 1R RESURFACING PROJECT FY 2013
6TH STREET (U.S. 40 HWY.)- FROM MONTEREY WAY
TO JUST WEST OF IOWA STREET (U.S. 59 HWY.)
CITY OF LAWRENCE, KANSAS
DOUGLAS COUNTY

FHWA REG NO.	STATE	PROJECT NO.	YEAR	SHEET NO.	TOTAL SHEETS
7	KANSAS	40-23 U-0086-01	2013	1	59

- 2 INCH MILL AND 2 INCH OVERLAY
- COLD PLASTIC PAVEMENT MARKING
- HEAT FUSED, PREFORMED, THERMOPLASTIC PAVEMENT MARKING
- PAVEMENT PATCHING

THERE IS NON-PARTICIPATING WORK TO BE PERFORMED AS PART OF THIS CONTRACT. IT INCLUDES:
-GEOMETRIC IMPROVEMENTS AT THE 6TH AND KASOLD DRIVE INTERSECTION AS WELL AS WIDENING ON 6TH STREET, WEST OF IOWA STREET, A BUS TURNOUT ON THE NORTH SIDE OF 6TH STREET, WEST OF SCHWARZ ROAD.

NOTE: TRAFFIC SHALL BE CARRIED THROUGH CONSTRUCTION DURING THE MILLING, OVERLAY, PAVEMENT MARKING, AND PAVEMENT RECONSTRUCTION OPERATIONS. ACCESS TO ADJACENT PROPERTIES SHALL BE MAINTAINED DURING THOSE TIMES.

THE CONTRACTOR MUST HAVE A TRAFFIC CONTROL PLAN APPROVED BY THE CITY AND KDOT PRIOR TO WORK STARTING.

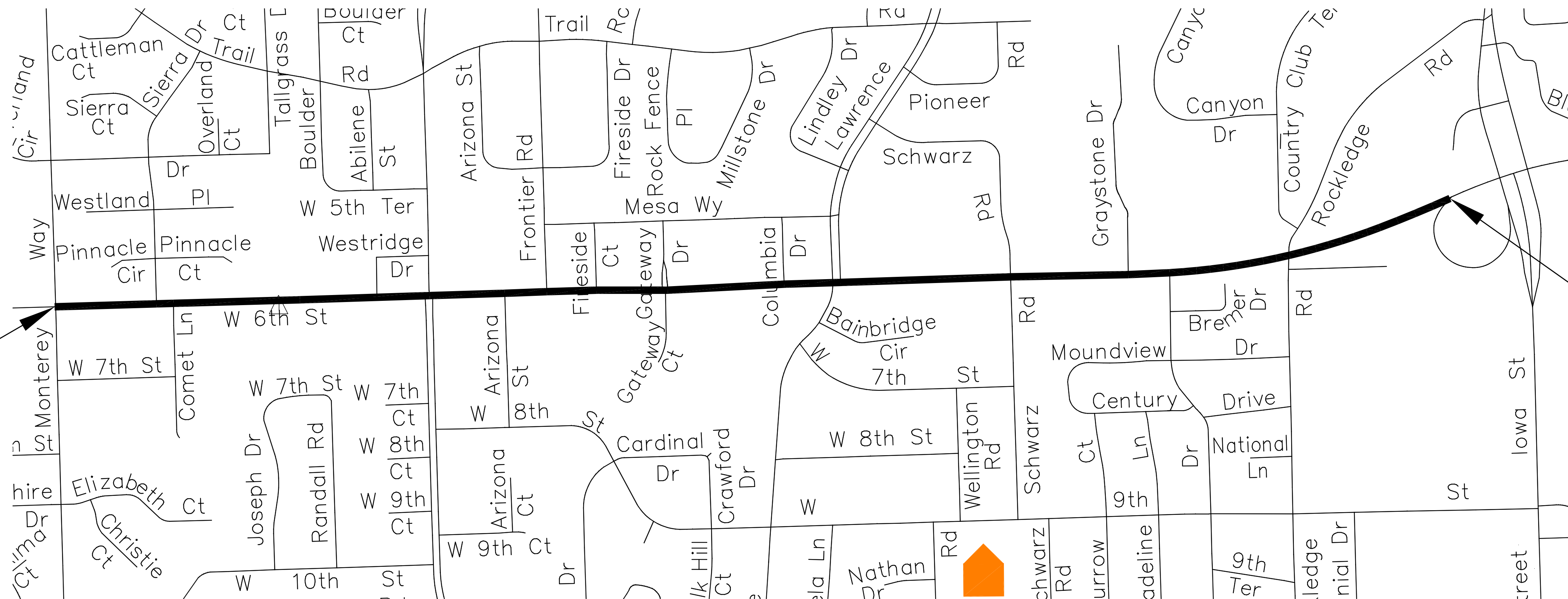

STA. 76+26.05 BEGIN
Project No. 40-23 U-0086-01
Klink 1R Resurfacing
Near 6th Street and Monterey Way
Intersection

AADT (6th Street) = 21,300
Posted Speed Limits:
From Monterey Way to 438' East
Of Lawrence Avenue=40mph
From 438' East Of Lawrence Avenue
To Iowa Street=35mph
Percentage Of Truck Traffic: 6%

LEGEND

- 1'100 Project Baseline
- ▨ Construction Limits (Participating Item)
- ▩ Construction Limits (Non-Participating Item)
- _{wv} Existing Water Valve Box
Any Valve Box Within Mill/Overlay Area Shall Be Adjusted
See Miscellaneous Details Sheet For Information.
- _{wm} Existing Water Meter Box
Any Meter Box Within Mill/Overlay Area Shall Be Adjusted
See Miscellaneous Details Sheet For Information.
- _{San MH} Existing Sanitary Sewer Manhole
Any Sanitary Sewer Manhole Within Mill/Overlay Area Shall Be Adjusted
See Miscellaneous Details Sheet For Information.
- _{St MH} Existing Storm Sewer Manhole
Any Storm Sewer Manhole Within Mill/Overlay Area Shall Be Adjusted
See Miscellaneous Details Sheet For Information.
- _{AT&T MH} Existing AT&T Manhole (To Be Adjusted BY OTHERS)
See Miscellaneous Details Sheet For Information.
- △ Existing Section Corner Monument Box

NOTE: Pavement Dimensions Reflect Back Of Curb To Back Of Curb Widths

UTILITY OWNER	UTILITY TYPE	CONTACT PERSON	PHONE NUMBER	EMAIL ADDRESS
Black Hills Energy	Gas	Charles C. Hoag	(785) 832-3944	chuck.hoag@blackhillscorp.com
Sunflower Broadband	Cable	Tim Templeton	(785) 312-6960	ttempleton@sunflowerbroadband.com
AT&T	Telephone	Kimball E. Parker	(785) 276-6142	kp3805@att.com
City of Lawrence - PW	Stormwater	Matt Bond	(785) 832-3142	mbond@ci.lawrence.ks.us
Westar Energy	Electric	Max F. Garcia	(785) 865-4850	Max.F.Garcia@WestarEnergy.com
City of Lawrence - Utilities	Water & Sewer	Philip Ciesielski	(785) 832-7831	pciesielski@ci.lawrence.ks.us
Lightcoore	Communication		(866)562-4349	
Southern Star Central Gas	Gas		(800)324-9696	

U.S. 40 HWY. (6TH STREET)

GROSS LENGTH OF PROJECT	7,592.91 ft.	1.438 mi.
NET LENGTH OF BRIDGES	0.000 ft.	0.000 mi.
NET LENGTH OF PROJECT	7,592.91 ft.	1.438 mi.

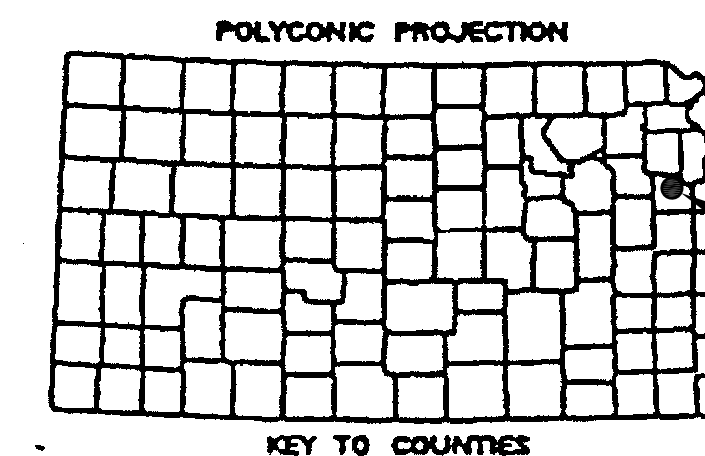

CITY OF LAWRENCE
2008 POPULATION: 90,520

STA. 152+18.96 END
Project No. 40-23 U-0086-01
Klink 1R Resurfacing
Near 6th Street and Iowa Street
Intersection

LOCATION FOR
'PRELIMINARY PLANS'
STAMP

RECOM. FOR APPROVAL - DATE	RECOM. FOR APPROVAL-DATE
CHIEF BUREAU OF TRAFFIC ENGINEERING KANSAS DEPARTMENT OF TRANSPORTATION	FEDERAL HIGHWAY ADMINISTRATION DEPARTMENT OF TRANSPORTATION
APPROVED - DATE	RECOM. FOR APPROVAL - DATE
STATE TRANSPORTATION ENGINEER KANSAS DEPARTMENT OF TRANSPORTATION	CITY ENGINEER CITY OF LAWRENCE, KANSAS

City Project No. PW1201

FHWA REG NO.	STATE	PROJECT NO.	YEAR	SHEET NO.	TOTAL SHEETS
7	KANSAS	40-23 U-0086-01	2013	25	59

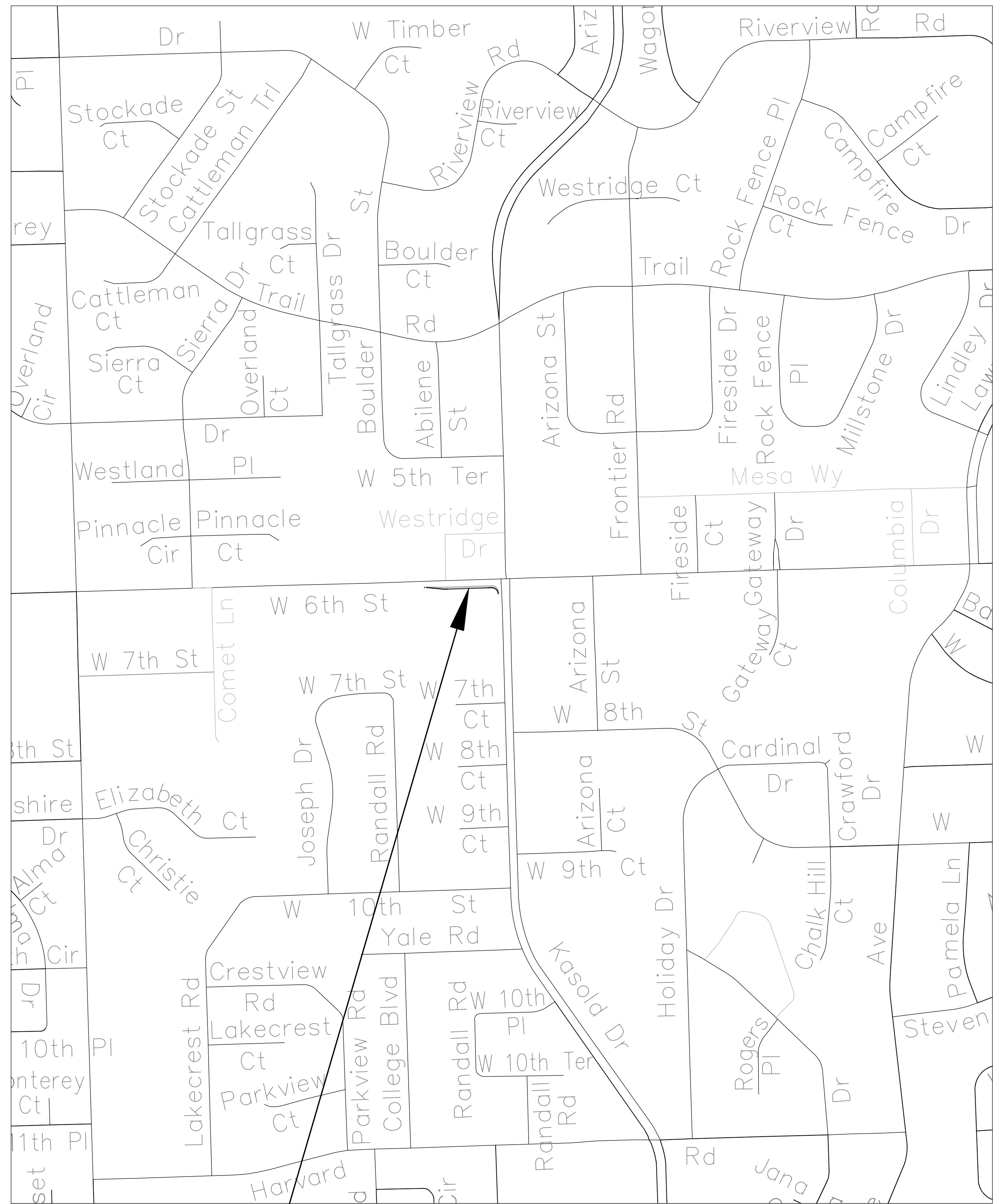

PROJECT LOCATION

PLANS FOR
EASTBOUND RIGHT TURN LANE
AT 6TH STREET (U.S. 40 HIGHWAY)
AND KASOLD DRIVE

CITY OF LAWRENCE, KANSAS
ENGINEERING DIVISION OF PUBLIC WORKS

PROJECT NO. PW1201

INDEX OF SHEETS

- 25 Title Sheet
- 26 Typical Section And Summary Of Quantities/General Notes
- 27 Plan Sheet
- 28-31 Cross-Sections

SHEET 25 OF 59

DATE	BY	REVISION



EASTBOUND RIGHT TURN LANE
AT 6TH STREET (U.S. 40 HIGHWAY) AND KASOLD DRIVE
TITLE SHEET AND GENERAL LOCATION MAP
 PROJECT NO. PW1201

SHOEB M. UDDIN **DAVID L. CORLISS**
CITY ENGINEER CITY MANAGER

FHWA REG NO.	STATE	PROJECT NO.	YEAR	SHEET NO.	TOTAL SHEETS
7	KANSAS	40-23 U-0086-01	2013	32	59

**PLANS FOR
PAVEMENT WIDENING ON
6TH STREET (U.S. 40 HIGHWAY)
WEST OF IOWA STREET (U.S. 59 HIGHWAY)**

**CITY OF LAWRENCE, KANSAS
ENGINEERING DIVISION OF PUBLIC WORKS**

PROJECT NO. PW1201

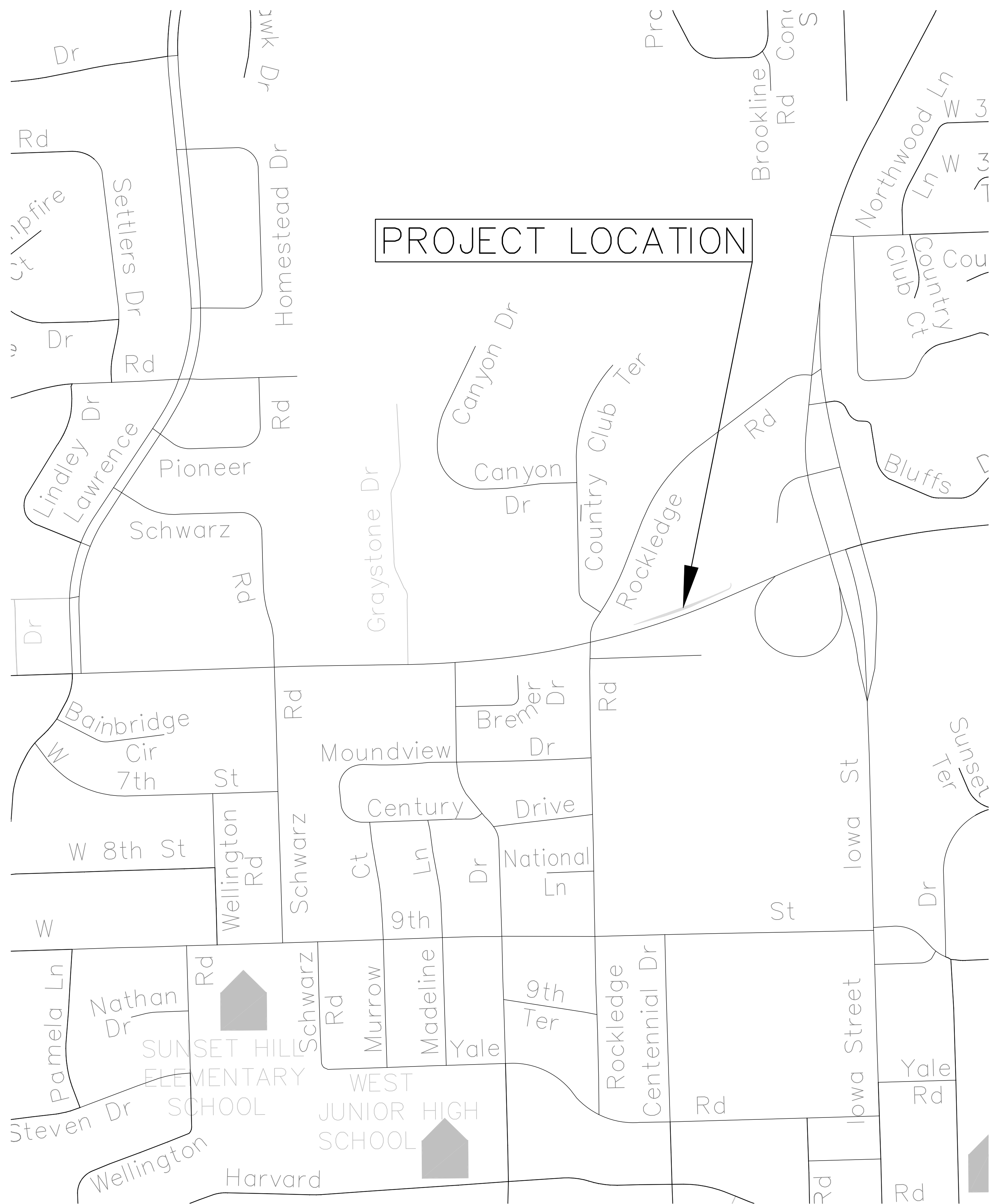

INDEX OF SHEETS

32.	Title Sheet
33.	Plan And Profile Sheet
34.-35.	Cross Sections

SHEET 32 OF 59

DATE	BY	REVISION



PAVEMENT WIDENING ON 6TH STREET (U.S. 40 HIGHWAY)
WEST OF IOWA STREET (U.S. 59 HIGHWAY)
TITLE SHEET AND GENERAL LOCATION MAP
PROJECT NO. PW1201

SHOEB M. UDDIN DAVID L. CORLISS
CITY ENGINEER CITY MANAGER

FHWA REG NO.	STATE	PROJECT NO.	YEAR	SHEET NO.	TOTAL SHEETS
7	KANSAS	40-23 U-0086-01	2013	36	59

**PLANS FOR
 BUS TURNOUT ON
 6TH STREET (U.S. 40 HIGHWAY)
 WEST OF SCHWARZ ROAD**

CITY OF LAWRENCE, KANSAS
ENGINEERING DIVISION OF PUBLIC WORKS

PROJECT NO. PW1201

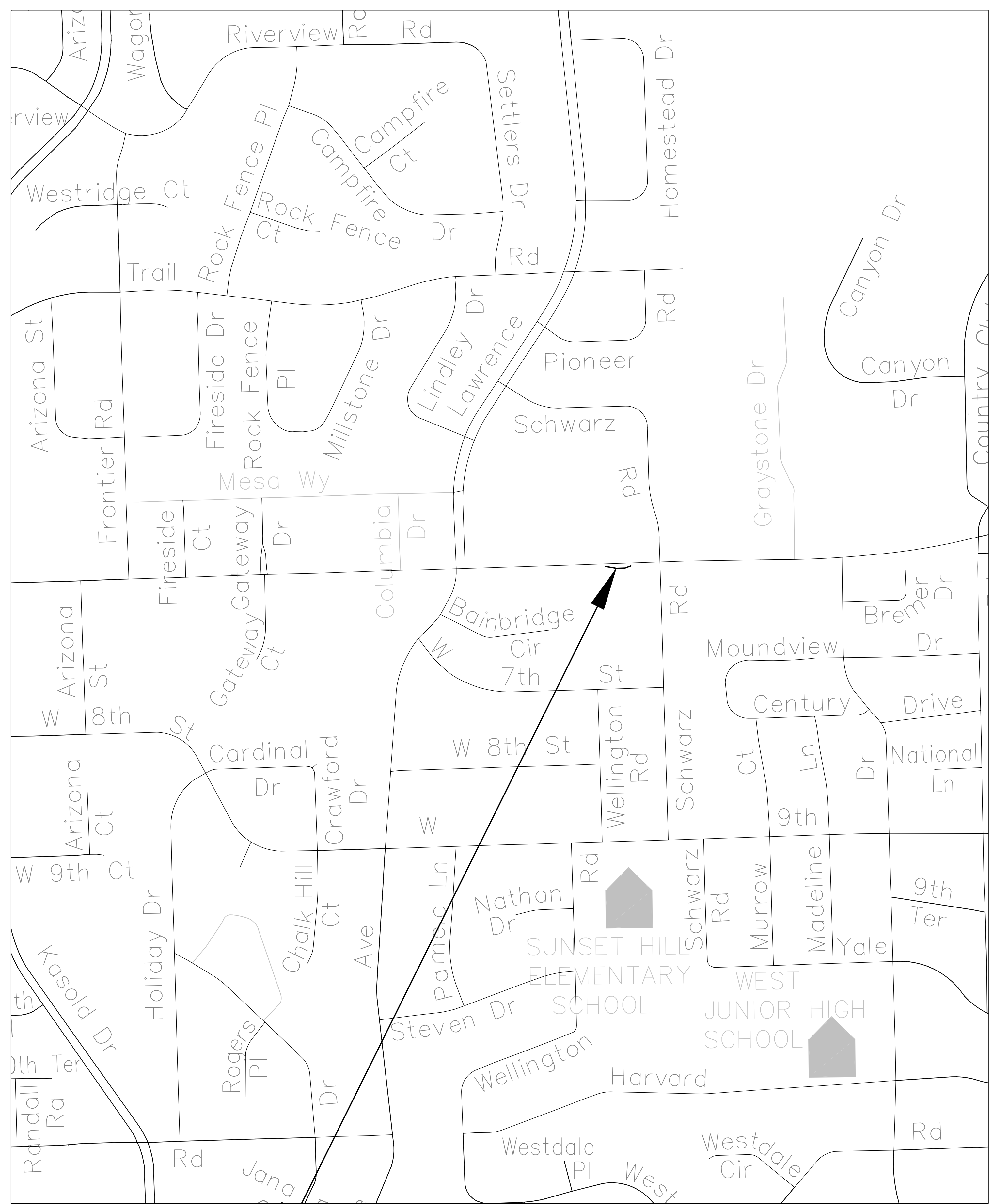

PROJECT LOCATION

INDEX OF SHEETS

36.	Title Sheet
37.	Plan Sheet
38.-39.	Cross Sections

SHEET 36 OF 59

DATE	BY	REVISION



BUS TURNOUT ON 6TH STREET (U.S. 40 HIGHWAY)
WEST OF SCHWARZ ROAD
TITLE SHEET AND GENERAL LOCATION MAP
 PROJECT NO. PW1113

SHOEB M. UDDIN **DAVID L. CORLISS**
CITY ENGINEER CITY MANAGER