

City of Lawrence  
Traffic Safety Commission Agenda  
June 7, 2010-7:00 PM  
City Commission Room, City Hall

MEMBERS: Jim Woods, Chair; Ken Miller, Vice-Chair; Dan Harden; Richard Heckler;  
Jason Novotny; Edwin Rockrock; Robin Smith; and John Ziegelmeier Jr.

**Anyone who wishes to be notified when an item will be heard by the City Commission must provide their name and a telephone number or an e-mail address.**

ITEM NO. 1: Review and approve the minutes of the Traffic Safety Commission meeting, May 3, 2010.

ITEM NO. 2: Consider request to establish a MID-BLOCK CROSSWALK on Kentucky Street between 12<sup>th</sup> Street & 13<sup>th</sup> Street.

Facts:

1. Kentucky Street is a one-way street, classified as a "collector" street, with two northbound lanes of traffic with a posted speed limit of 30mph.
2. Kentucky Street carries approximately 8500 vehicles per day.
3. A nation-wide survey of crosswalks found no significant difference in the crash-rate for marked vs. unmarked crosswalks under similar conditions.
4. Staff has been tracking pedestrian crashes for the past eight (8) years; during that time period, there have been no reported pedestrian crashes in this area.
5. If approved, a sidewalk and ramp would have to be constructed on the west side of the street and a ramp would have to be constructed on the east side of the street in order to separate pedestrians from vehicular traffic entering and exiting the parking lot, in addition to pavement markings, signing at the crosswalk and advance signing.

ITEM NO. 3: Consider request to establish NO PARKING along the south side of 19<sup>th</sup> Terrace between Naismith Drive & Ousdahl Road.

Facts:

1. This portion of 19<sup>th</sup> Terrace is currently posted NO PARKING NOVEMBER 1 TO MARCH 31.

ITEM NO. 4: Consider request to construct TRAFFIC CALMING DEVICES on 9<sup>th</sup> Street between Locust Street & Walnut Street.

Facts:

1. 9<sup>th</sup> Street between Locust Street & Walnut Street is classified as a "local" street.
2. The city's *Traffic Calming Policy* (attached) provides criteria for permitting traffic calming devices on "local" streets.
3. The statutory speed limit on 9<sup>th</sup> Street is 30mph; traffic data collected May 25-26, 2010 found an average of 463 vehicles per day traveling at an 85<sup>th</sup> percentile speed of 36.8mph.
4. Therefore, this location meets the minimum criteria for consideration of traffic calming devices.

ITEM NO. 5: Elect Chair and Vice-Chair of the Traffic Safety Commission for the period 2010-2011.

ITEM NO. 6: Public Comment.

ITEM NO. 7: Commission Items.

ITEM NO. 8: Miscellaneous.

City Commission action on previous recommendations:

None.



RECEIVED  
 APR 27 2010  
 PUBLIC WORK

April 23, 2010

Traffic Safety Commission  
 City of Lawrence  
 6<sup>th</sup> & Massachusetts  
 Lawrence, KS 66044

Dear Traffic Safety Commission:

We are writing you to request some type of cross walk to be installed at St. John the Evangelist Church and School between 12<sup>th</sup> and 13<sup>th</sup> Streets of Kentucky Street.

St. John Church holds 7 worship services over the course of each weekend. The church also has a daily service each morning at 7:30 am. There is an average of 200 people attending each weekend service and 40 people each weekday service. Parishioners of St. John park in the parking lot on the west side of Kentucky (across the street from the church) and attempt to cross two lanes of traffic to attend services.

St. John School has a number of school parents who also use this parking lot and walk their child/ren across the street, again, attempting to cross two lanes of traffic to attend school. The preschool is of the most concern as there is not a drive through traffic pattern on our property for parents to use.





The church also hosts a number of "special events" such as weddings, funerals, socials, etc. Thus, the attempt to cross two lanes of traffic is a constant challenge.

This has been a concern for a number of years and seems to be increasingly dangerous with the increased traffic on Kentucky Street. We would leave the specifics of the type and location of the crosswalk up to the best discretion of the commission.

If you have any further questions, please do not hesitate to contact one of us.

Thank you for your time in considering this request.

Sincerely,



  
 Fr. John Schmeidler, OFM Cap    Mrs. Pat Newton    Cris Denning    Jeff Jenicke  
 Pastor    Principal    Operations Manager    Maintenance

  
 Jim Benson  
 Facilities Committee

  
 Sam Jahn    Michael Kennedy  
 Facilities Committee    Facilities Committee

St. John the Evangelist Catholic Church  
 1229 Vermont Street  
 Lawrence, KS 66044  
 Phone: 785.843.0109  
 Fax: 785.749.5064

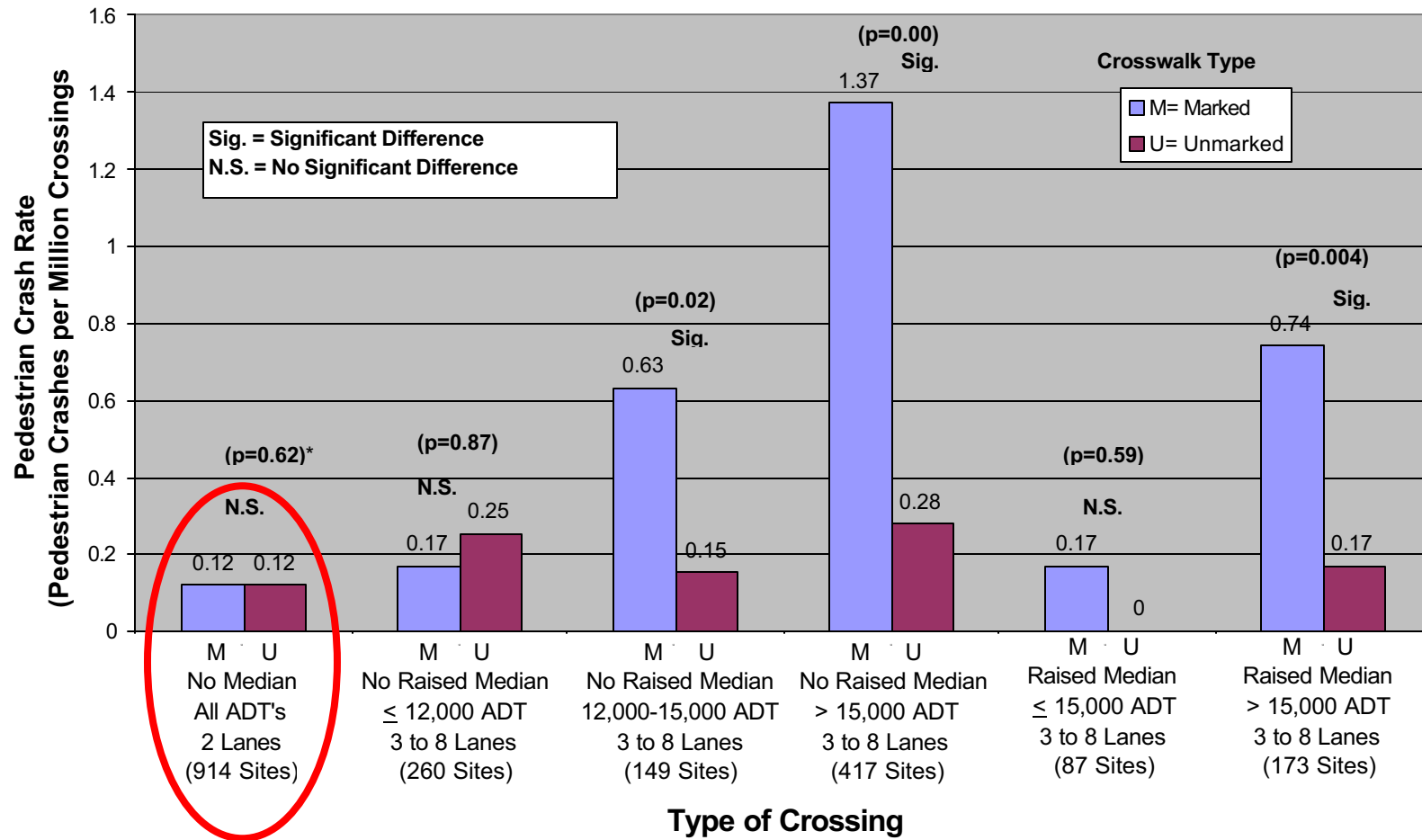

Figure 4. Pedestrian crash rate vs. type of crossing.



Kentucky St



## David Woosley

---

**From:** Edmonds, Tiffany Renee [tedmonds@ku.edu]  
**Sent:** Monday, May 10, 2010 10:23 AM  
**To:** David Woosley  
**Subject:** Traffic Street Sign - Change Request

Could you please verify that you received this?  
~~~~~

To Whom It May Concern:

Currently there are "No Parking November through March" parking signs on the South side of the 1400-1600 blocks of W 19<sup>th</sup> Street Terrace. (Between Osdahl Road & Naismith Drive)

I am asking you to consider changing these signs to a permanent "No Parking" sign for the following reasons:

- 1) There are no sidewalks on either side of the street
- 2) There is heavy traffic (both pedestrian and automotive) on that street due to its close location to KU
- 3) There are a lot of students, children and pet owners in this area
- 4) Both sides of the street fill up with parked cars due to the location leaving a narrow path for driving
- 5) It is very dangerous to walk down that street with both sides filled completely with cars and no where to go when someone comes speeding by

I really don't want to be injured or killed while walking with my daughter and dog. Please consider my request to switch the current signs to a permanent status.

Thank you for your time and thoughtfulness,

Tiffany Edmonds  
1719 W 19<sup>th</sup> Ter  
Lawrence, KS 66046  
[tedmonds@ku.edu](mailto:tedmonds@ku.edu)  
785-760-2824

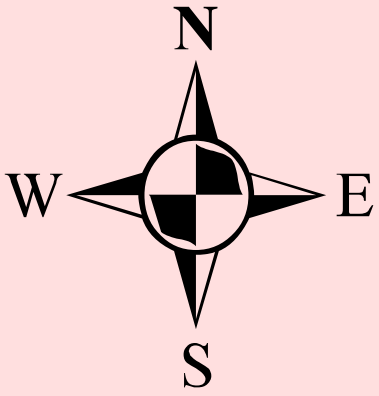

KU

W 19th St

W 19th Ter

W 20th St

Ousdahl Rd

Clifton Ct

Hillview Rd

Emerald Dr

Naismith Dr

Naismith Dr

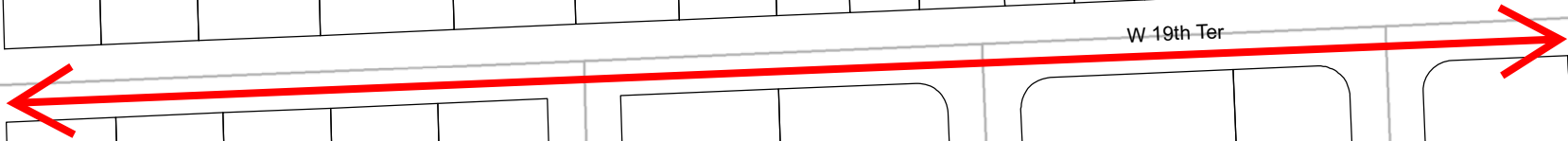

**David Woosley**

---

**From:** Will Robarge [wrobarge@TreanorArchitects.com]  
**Sent:** Tuesday, May 18, 2010 10:40 AM  
**To:** David Woosley  
**Cc:** David Woosley  
**Subject:** Traffic Calming Request

Sir / Ma'am,

I am writing to you in regards to my increasing concern for the activities surrounding the Pink Flamingo Gentlemen's Club (located in North Lawrence City, off 9th Street.) I am a resident in the vicinity to this club, and for the 4 years in which I have lived here, I have witnessed car accidents (most due to drunk driving), property damage due to swerving/speeding vehicles, speeding vehicles coming from the club parking lot and heading down 9th Street and onto Maple & Locusts streets which are residential streets with children playing and pedestrian traffic adjacent to the road, night time motorcycle groups riding by at high speeds and at late hours, night & day time drag racing both car and motorcycles along N 9th street and down Locust St., a wide variety of food and clothing items thrown in my yard during the day and over the late hours of the night, the list goes on and on. I've even had my truck bed used as a trash can and my cab broken into as well. I believe you get the picture. I have contacted Keith Dabney with the County Zoning & Codes Dept. in regards to these issues, and he indicated that the City of Lawrence is who I should contact. I then contacted Mr. Scott McCullough with Planning and Development, who then referred me to Mr. David Woosley with the Public Works Department. Mr. Woosley provided me with this email address to officially submit a request for a speed hump to help alleviate the speeding issues and the danger it is presenting to our neighborhood.

So I am writing to request a traffic calming device be installed (speed hump) along N 9th Street, between Walnut and Locust streets. It's my perception that the device most ideally suited for this type of application would be a speed hump or two. Please let me know if this email is all that needs to be done for a request, or if there is a form that needs to be filled out.

Thank you,  
Will

**Will Robarge** Associate AIA, CSI | [wrobarge@treanorarchitects.com](mailto:wrobarge@treanorarchitects.com) | P. 785.842.4858  
**Treanor Architects, P.A.** | 110 McDonald Dr. Ste. 192 | Lawrence, KS 66044

Kansas City, MO | Lawrence, KS | St. Louis, MO | Topeka, KS  
[www.treanorarchitects.com](http://www.treanorarchitects.com)



# TRAFFIC CALMING POLICY

Resolution No. 6602, August 23, 2005

1. TRAFFIC-CALMING DEVICES may include but are not limited to Traffic-Calming Circles, Speed Humps and Speed Cushions, Speed Tables, Partial Diverters, Full Diverters, Center Island Narrowing, Chokers, and Road Closures; however, roundabouts are traffic management devices and are not subject to this policy.
2. TRAFFIC-CALMING DEVICES may be permitted on "local" streets as designated by the City's Major Thoroughfares Map, and under any one of the following conditions:
  - A. The 85<sup>th</sup> percentile speed of traffic is 5 mph or greater over the speed limit, or
  - B. The 24-hour two-way traffic volume is greater than 1000, or
  - C. Cut-through traffic comprises more than 50% of the traffic during the peak hour of the day, or
  - D. Where no single condition is satisfied, but where any two of A, B or C above are satisfied to the extent of 80 percent or more of the stated values.
3. TRAFFIC-CALMING DEVICES (except SPEED HUMPS) may be permitted on "collector" streets as designated by the City's Major Thoroughfares Map, under any one of the following conditions:
  - A. The 85<sup>th</sup> percentile speed of traffic is 5 mph or greater over the speed limit, or
  - B. The 24-hour two-way traffic volume is greater than 3000, or
  - C. Cut-through traffic comprises more than 50% of the traffic during the peak hour of the day, or
  - D. More than 50% of the frontage of the roadway consists of residential lots with the houses facing the roadway in question, or
  - E. Where no single condition is satisfied, but where any two of A, B, C or D above are satisfied to the extent of 80 percent or more of the stated values.
4. Traffic data will be collected with city personnel using city equipment only. In the event that a requested location does not meet the minimum requirements as stated in 2 or 3 above, subsequent requests will not be considered for a minimum of one year.
5. The Lawrence-Douglas County Fire & Medical Department, the Police Department, the Public Works Department and the Traffic Safety Commission must review all requests for TRAFFIC-CALMING DEVICES before being presented to the City Commission.
6. If a project is approved by the City Commission, the City Commission will determine financing of the construction. The City Commission may require 0-100% of the costs to be paid by the group or neighborhood making the request.
7. After a project is approved and funded by the City Commission, TRAFFIC-CALMING DEVICES will only be constructed at a location if 70% or more of the property owners within 300 feet measured along the centerline of the street in each direction approve of the installation or if directed by the City Commission. The individual, group or neighborhood making the request shall be responsible for obtaining the property owners' and residents' approval in writing and submitting it to the city.
8. Once installed, TRAFFIC-CALMING DEVICES may only be removed at a location if more than 70% of the property owners and residents within 300 feet measured along the centerline of the street in each direction approve of the removal or if directed by the City Commission. The individual, group or neighborhood making the request shall be responsible for obtaining the property owners' and residents' approval in writing and submitting it to the city.
9. TRAFFIC CALMING DEVICES may initially be landscaped (if appropriate) by the city, provided that the group or neighborhood making the request agrees in writing to maintain the landscaping or pursuant to the payment of a landscape maintenance fee. No privately installed landscaping is permitted unless approved by the city in writing.

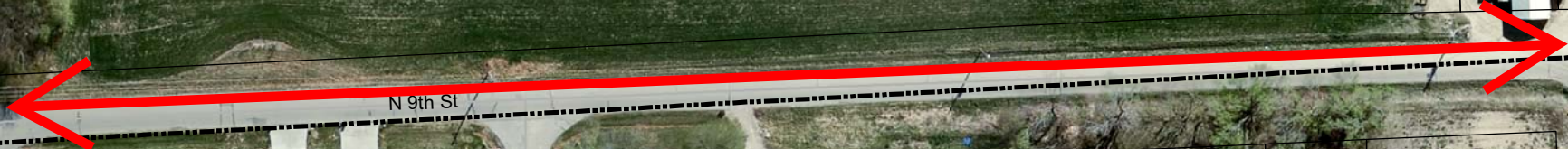

N 9th St

Locust St

Elm St

Walnut St

